

TOWNSHIP 1 N., RANGE 21 E.

4

3

9

10

16

15

23

24

26

25

35

36

ANGE 21 E.

5-2-1

--	--	--

3

2

1

--	--	--

10

11

12

15

14

13

22

23

24

19

20

J. Stephens

Arthur Wheelhouse

29

Note:

Streams and roads, except in the vicinity of irrigated land, are sketched in approximate location.

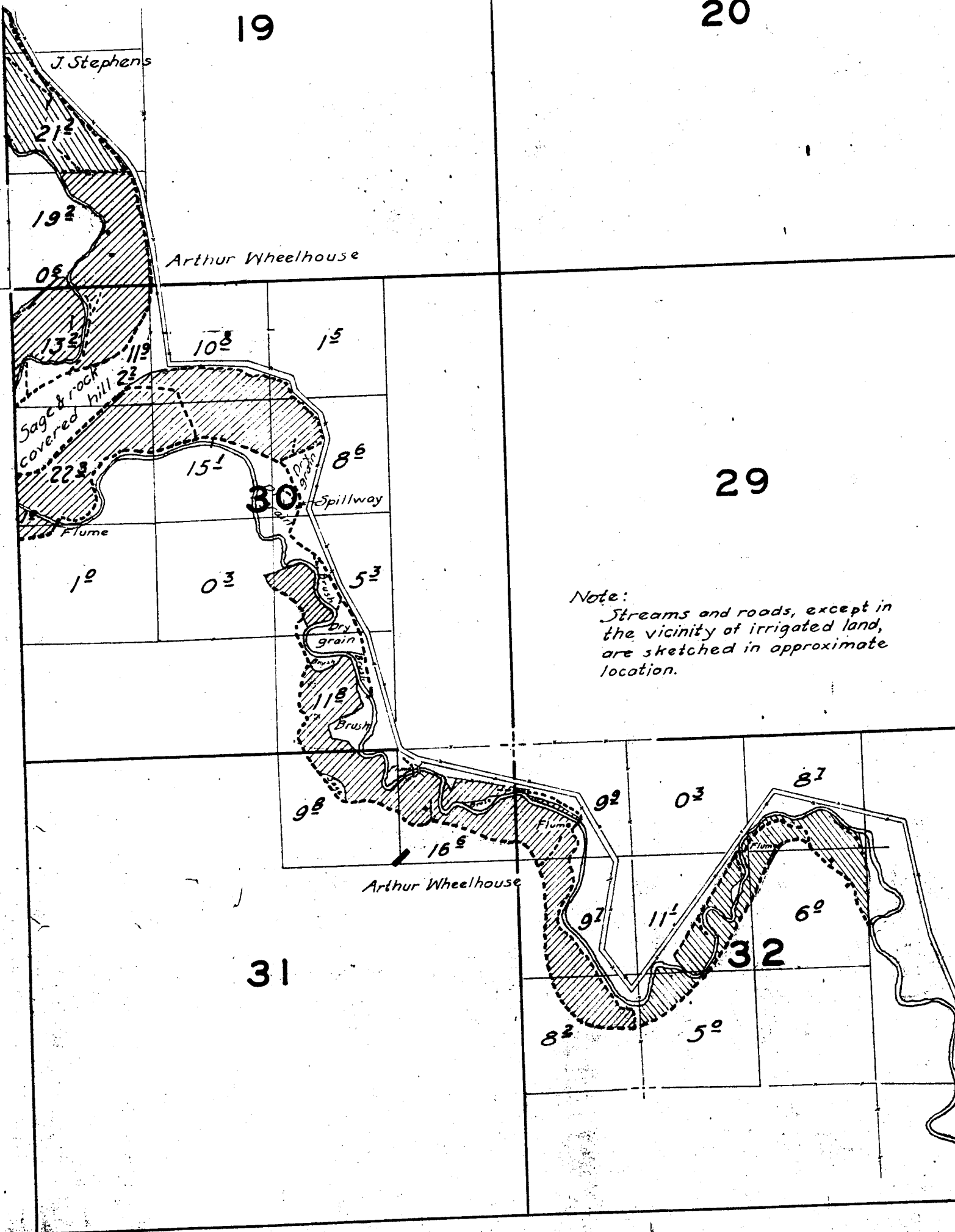

31

32

29

*roads, except in
of irrigated land,
d in approximate*

28

27

Surveyed April 28 and 29, 1985

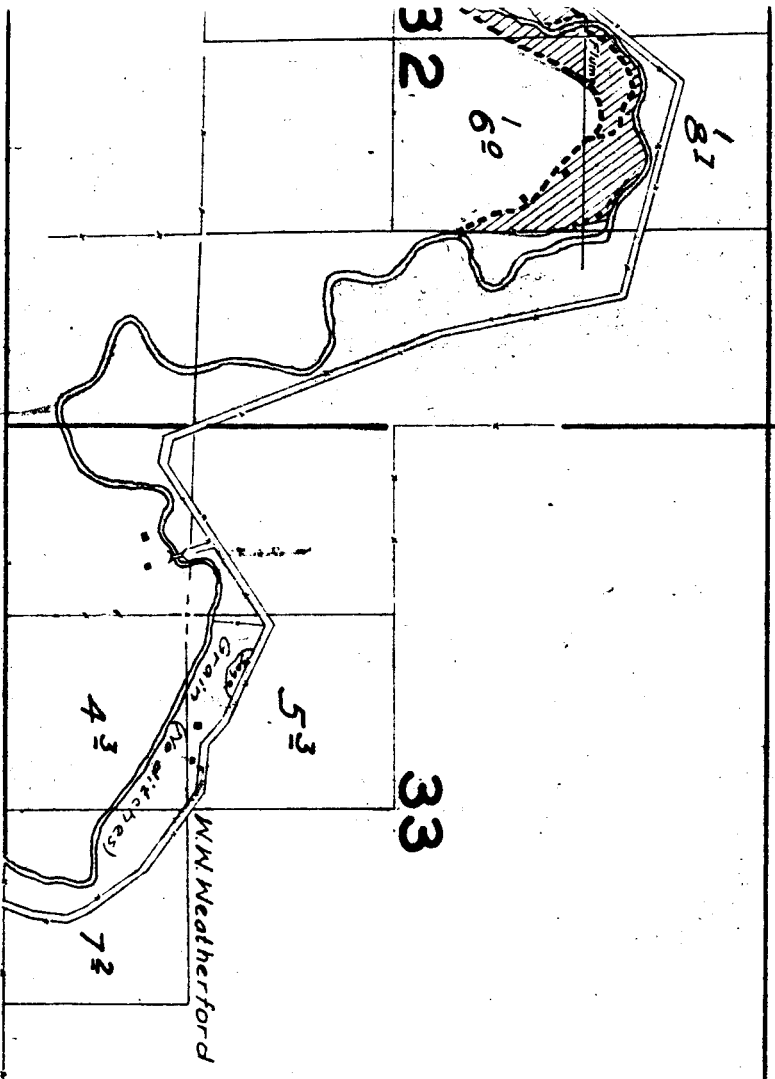

17

16

15

20

21

22

TOWNSHIP

6	5	4
7	8	9

16

17

18

21

20

19

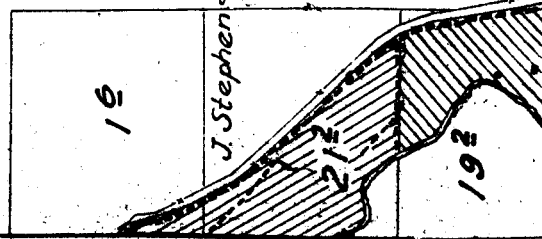

ANGE 20 E.

4-2-1

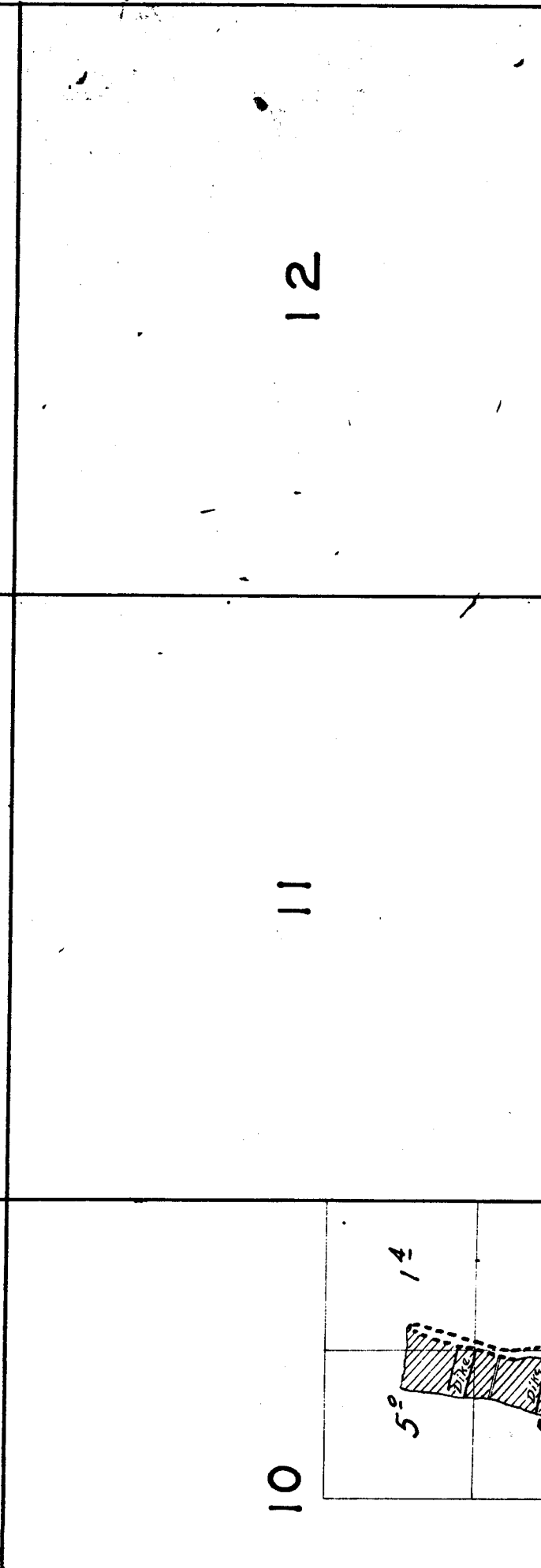
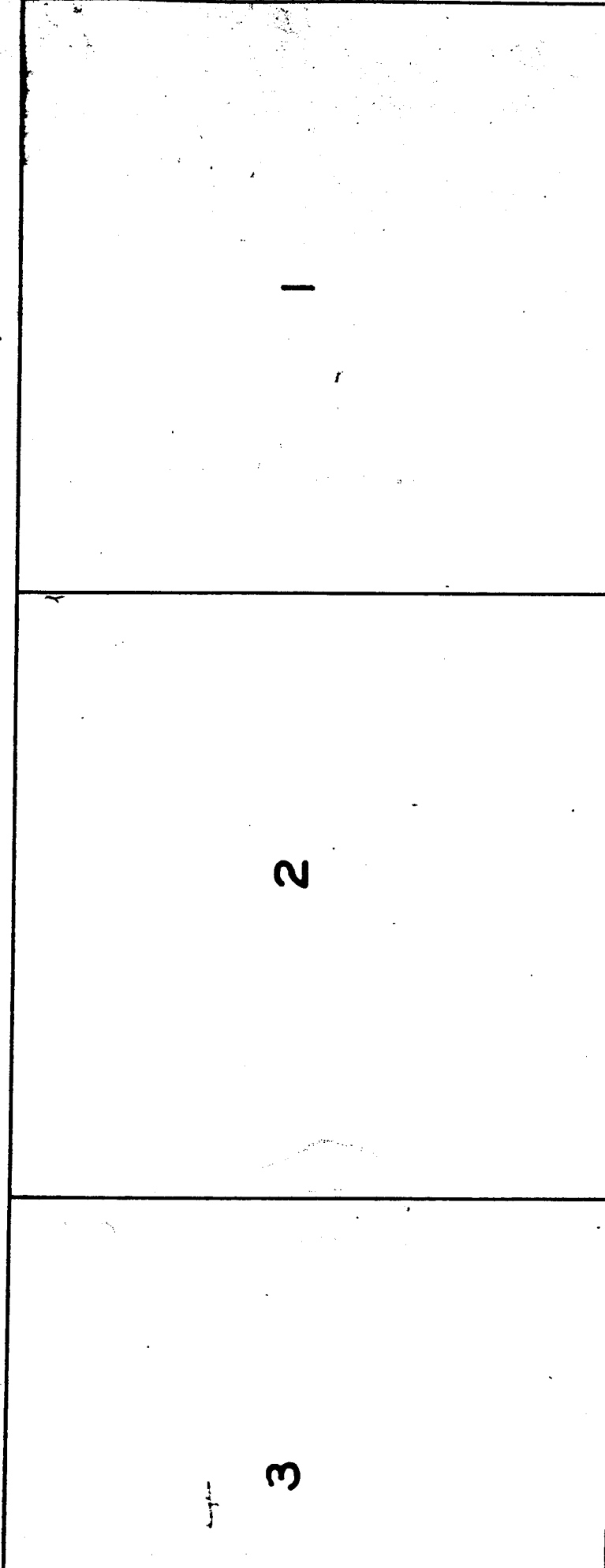

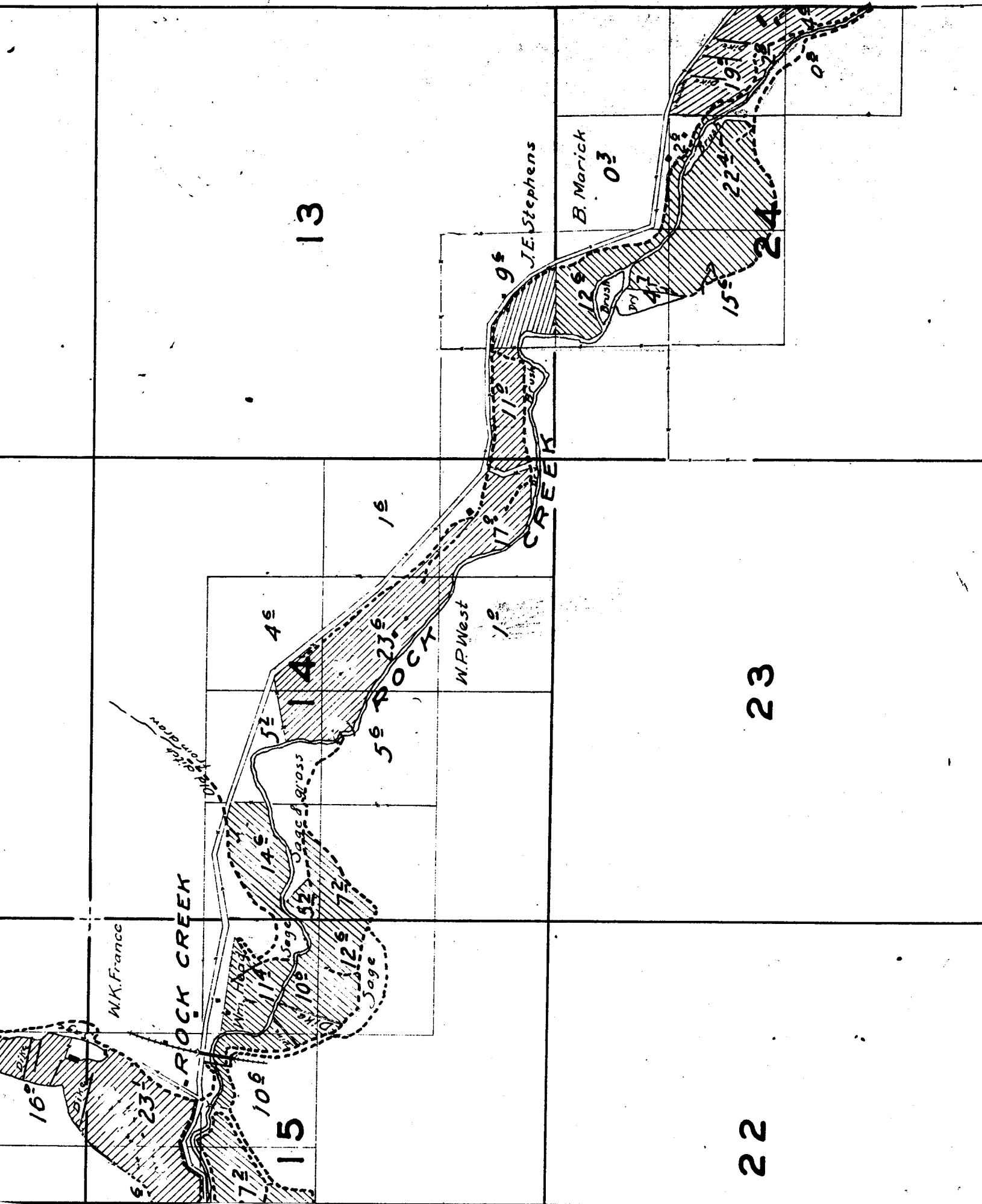

13

J.E. Stephens

B. Marick

03

W.P. West

W.K. France

ROCK CREEK

ROCK CREEK

SAGEBRUSH CREEK

22

23

24

23

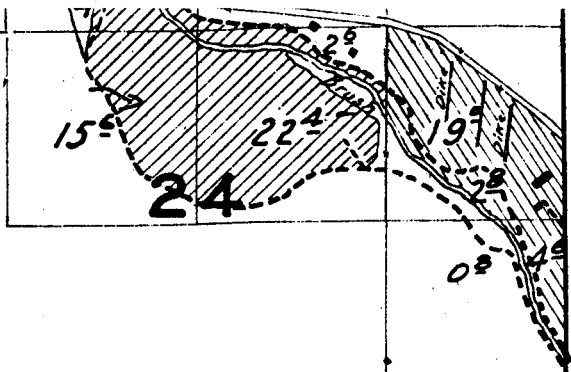

26

25



35

36

19

20

30

29

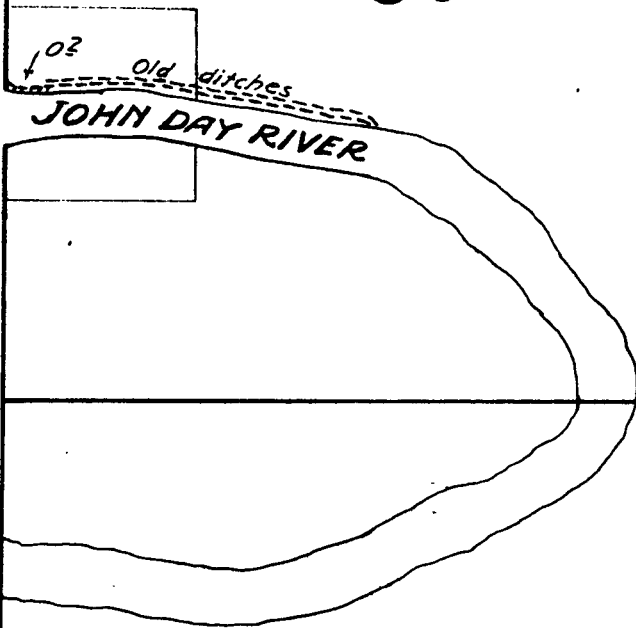

31

32

TOWNSHIP 1 N., RANGE 20 E

4

3

9

10

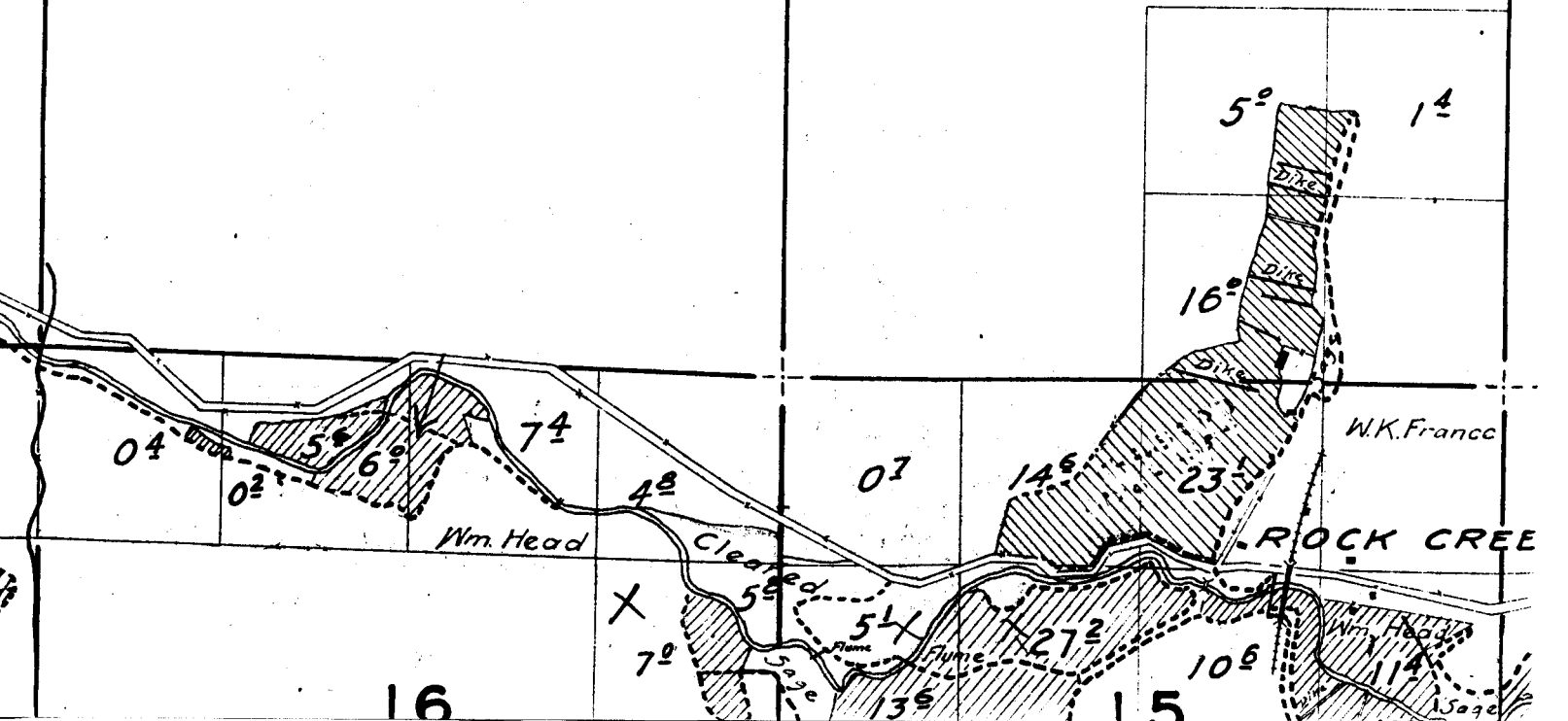

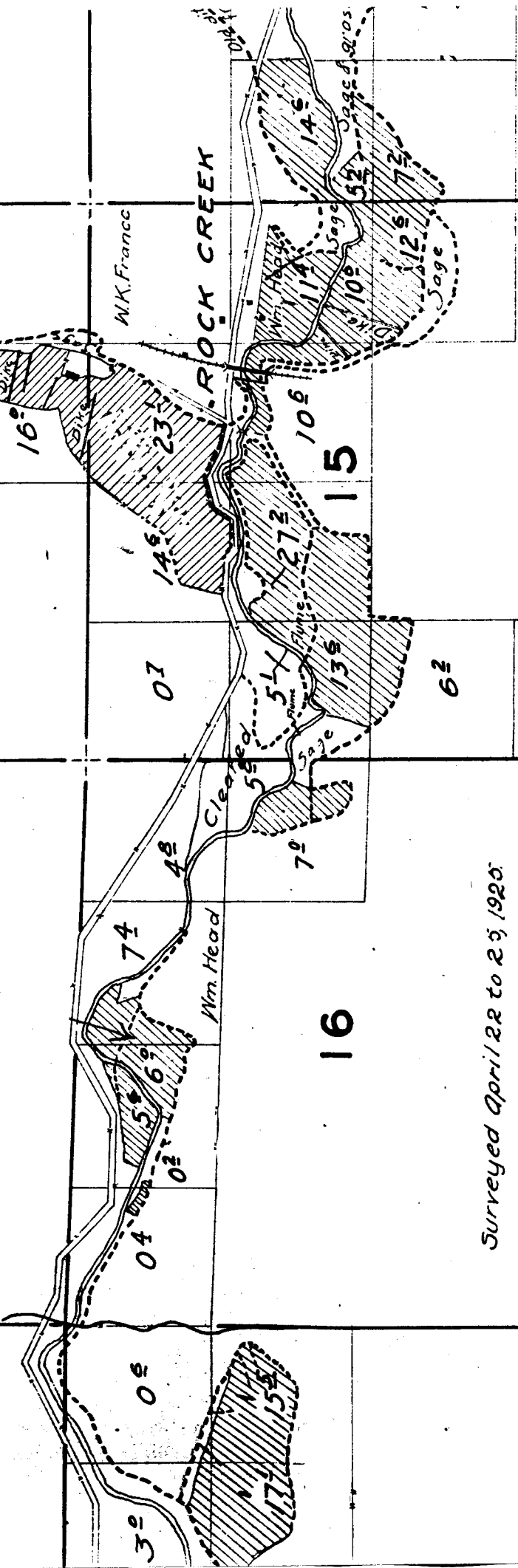

Surveyed April 22 to 23, 1920.

Note:
Streams and roads, except in
the vicinity of irrigated land,
are sketched in approximate
location.

21

22

28

27

33

34

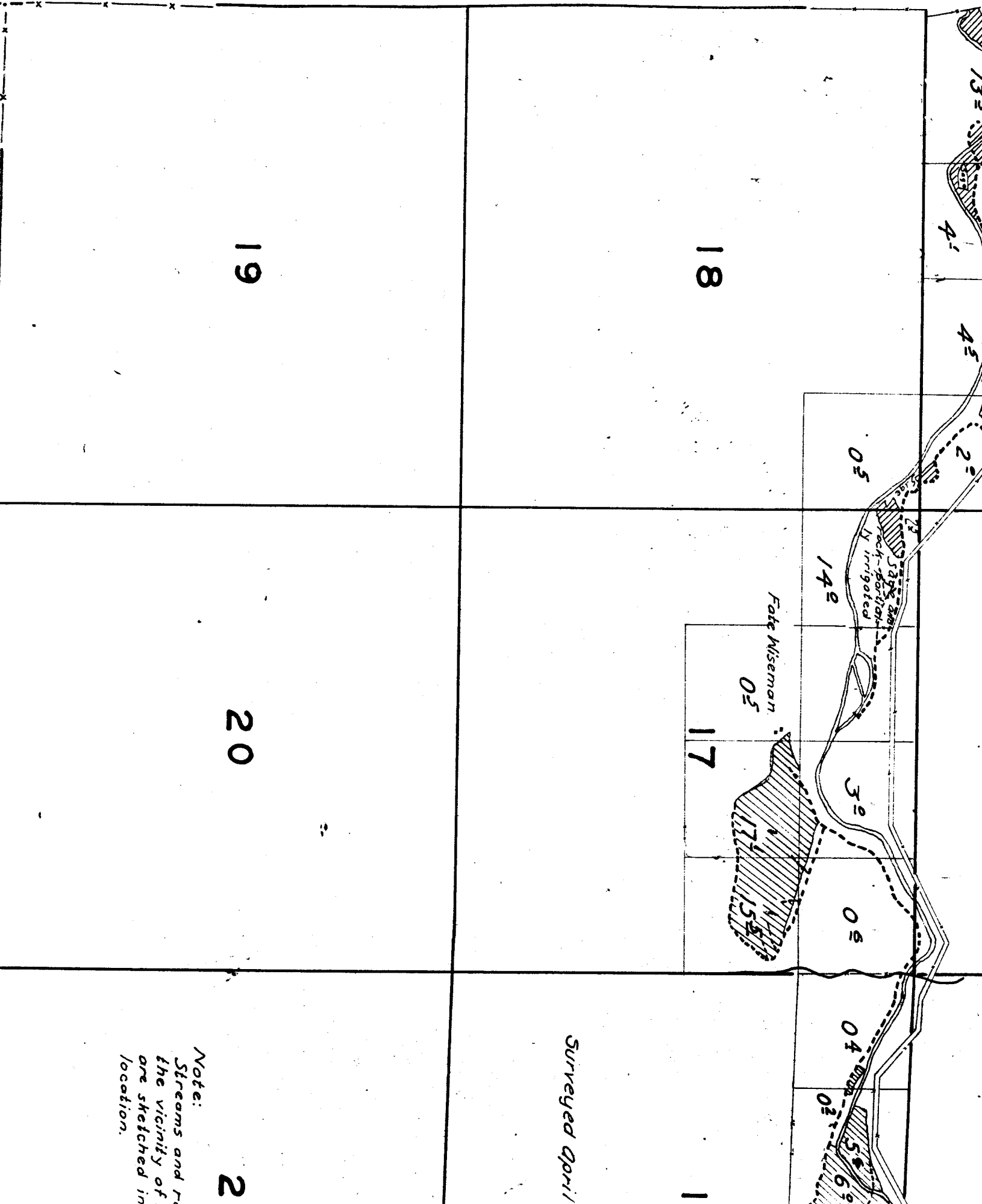

Surveyed April

*Note:
Streams and
the vicinity of
are sketched in
location.*

19

18

20

17

2

1

