

# T.14&15S. R.16E. W.M.

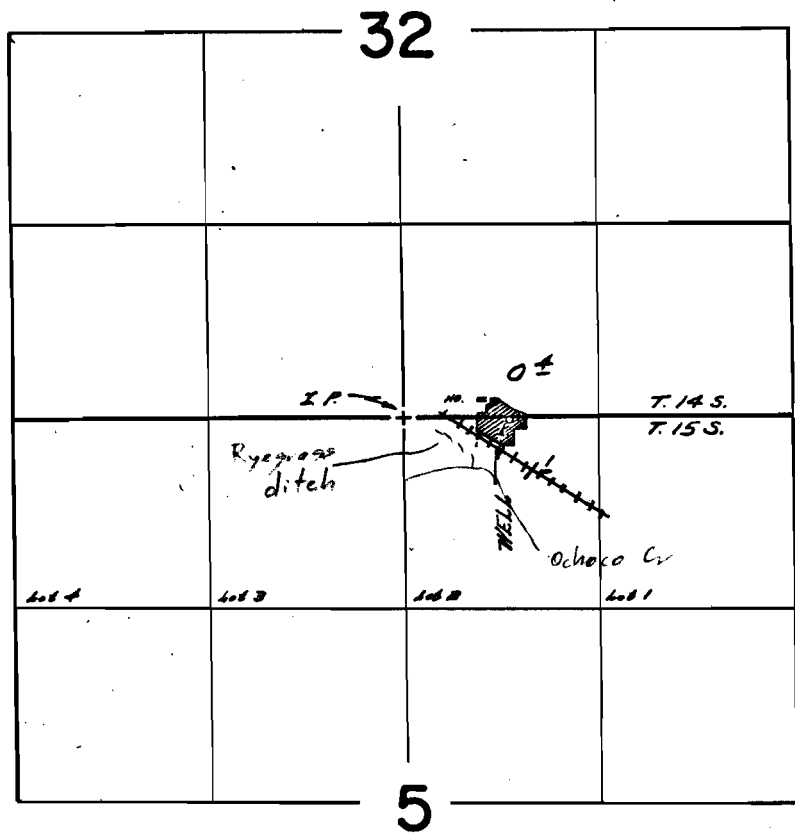

WELL LOCATED 20 FT. S. & 720 FT. E FROM NW COR. SEC. 6

## FINAL PROOF SURVEY UNDER

Application No. G-3641 Permit No. G-3421  
IN NAME OF

MARK O'KELLEY

Surveyed June 12 1968, by H. J. Ruppert