

T.36S.R.2W.W.M.

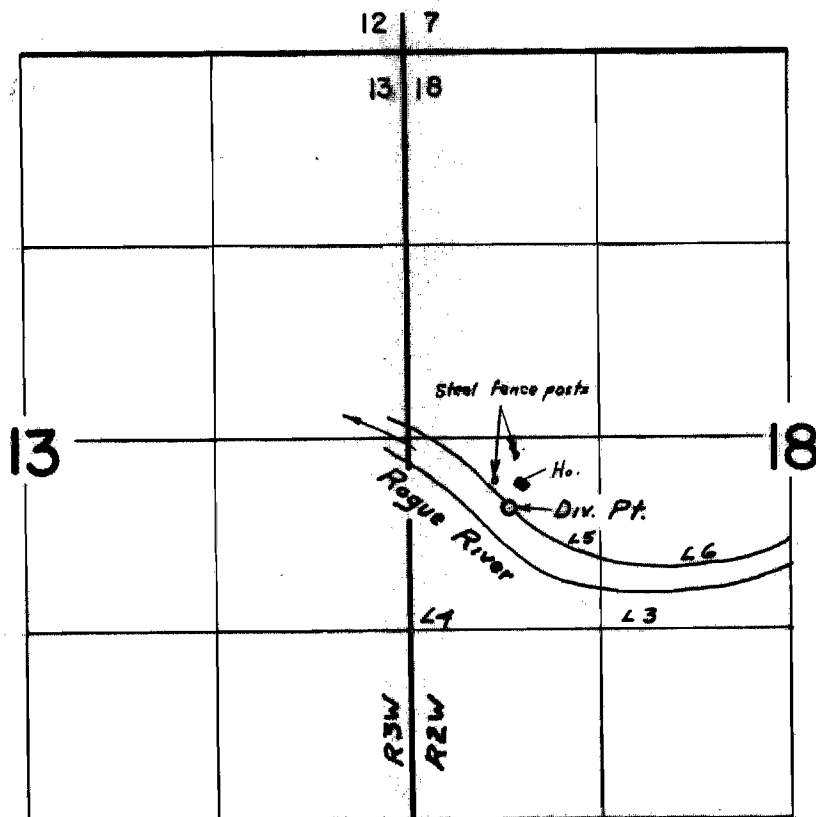

Div. Pt. located: 480 ft. S. E 690 ft. E. from W. 1/4 cor Sec. 18.

FINAL PROOF SURVEY
UNDER

Application No. 44880 Permit No. 33555
IN NAME OF

JOHN S. DAY

Surveyed Jun 3 1969, by L. E. Gould