

T.6S.R.8W.W.M.

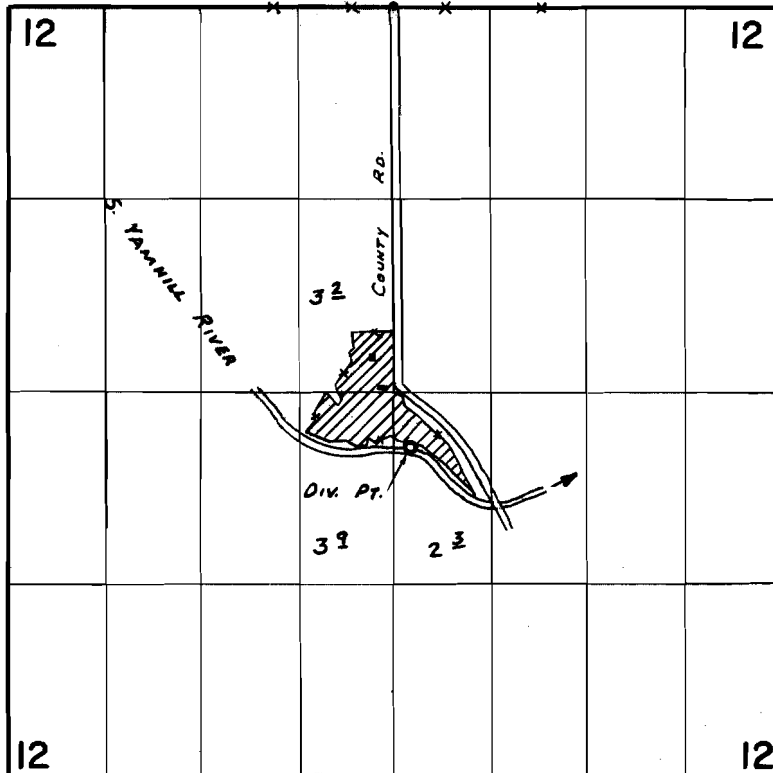

Div. Pt. LOCATED 3020 FT S. & 120 FT E. FROM N 1/4 COR. SEC. 12

FINAL PROOF SURVEY UNDER

Application No. 44360 Permit No. 33005
IN NAME OF

RICHARD RINK

Surveyed Nov. 28 1969, by D. BUELL