

T.3S.R.30E.W.M.

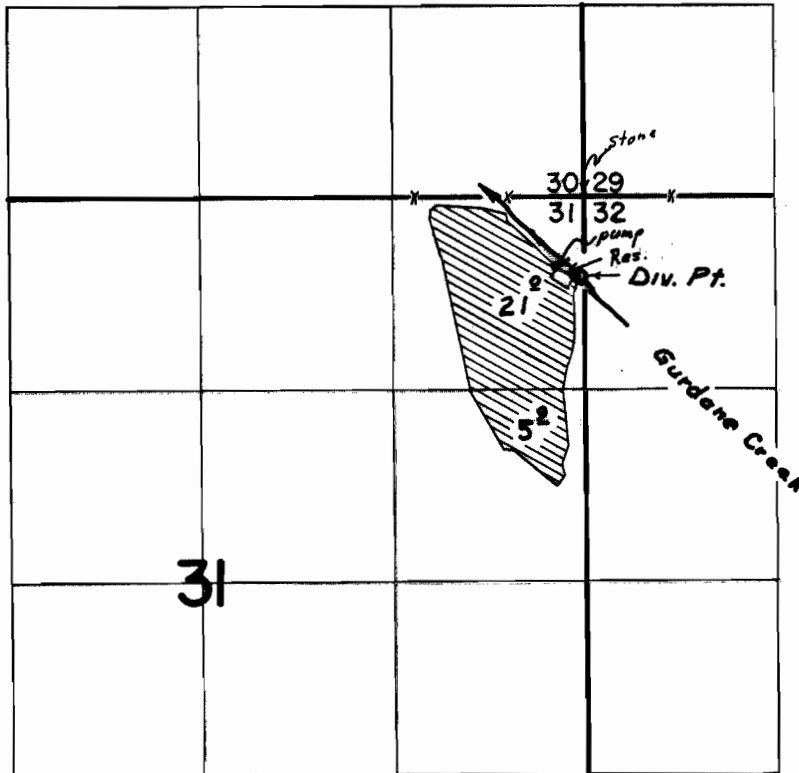

Div. Pt. located : 530 ft. S. & 20 ft. W. from NE cor. Sec. 31.

FINAL PROOF SURVEY
UNDER

R-38163 R-3163
Application No. 38164 Permit No. 28449
IN NAME OF
CON DOHERTY

Surveyed July 14 1969, by L. E. Gould