

T. 35S. R. 14W. W. M.

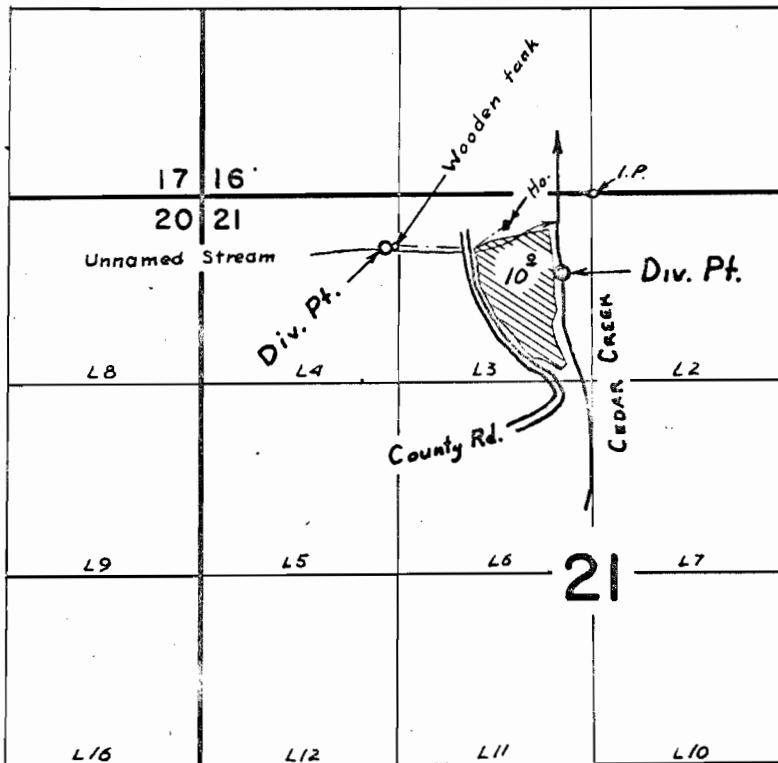

Diversion Points located: 370 ft. S. & 1410 ft. W.; and
540 ft. S. & 210 ft. W.; both from N. $\frac{1}{4}$ cor. Sec. 21.

FINAL PROOF SURVEY
UNDER

42981 32112
Application No. 39739 Permit No. 29488
IN NAME OF
DOROTHY FERN VINCENT &
ESTATE OF EUGENE MERLE VINCENT
Surveyed May 23, 1969, by L. E. Gould