

T.41S.R.13W.W.M.

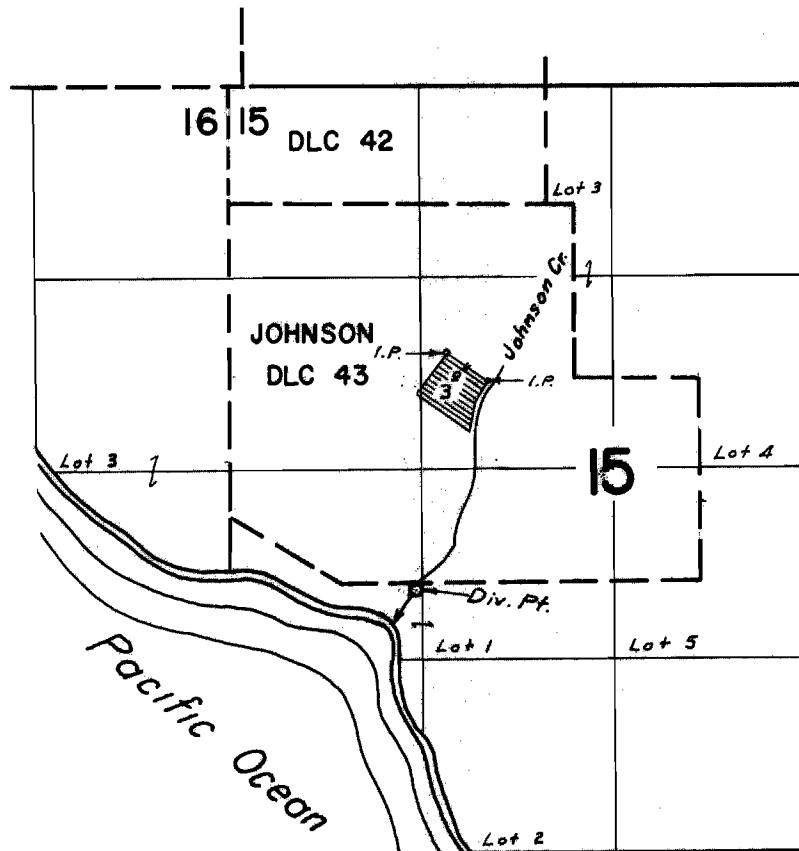

Div. Pt. located: 50 ft. S. & 1970 ft. W. From SE cor. Johnson DLC 43.

FINAL PROOF SURVEY
UNDER

Application No. 43678 Permit No. 32648
IN NAME OF

ROGER I. & DORIS A. OLIVER

Surveyed Sept. 10, 1969, by L. E. Gould