

# T.25 & 26S.R.29E.W.M.

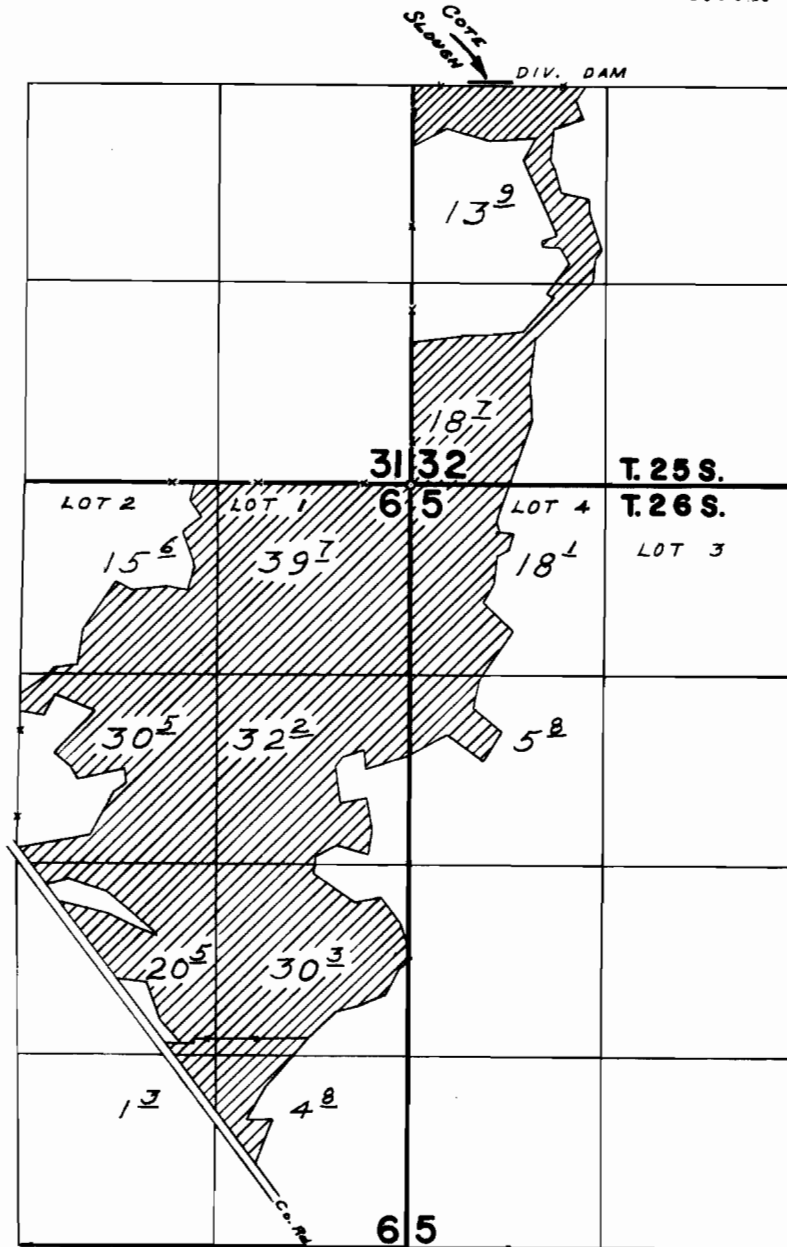

DIV. PT. LOCATED 2770' N & 510' E FROM SW COR. SEC. 32

## FINAL PROOF SURVEY UNDER

Application No. **32783** Permit No. **25866**  
IN NAME OF

**A. A. HURLBURT**

Surveyed **SEPT. 19** 1968, by **W. J. RUPPERT**