

T.20S.R.3W.W.M.

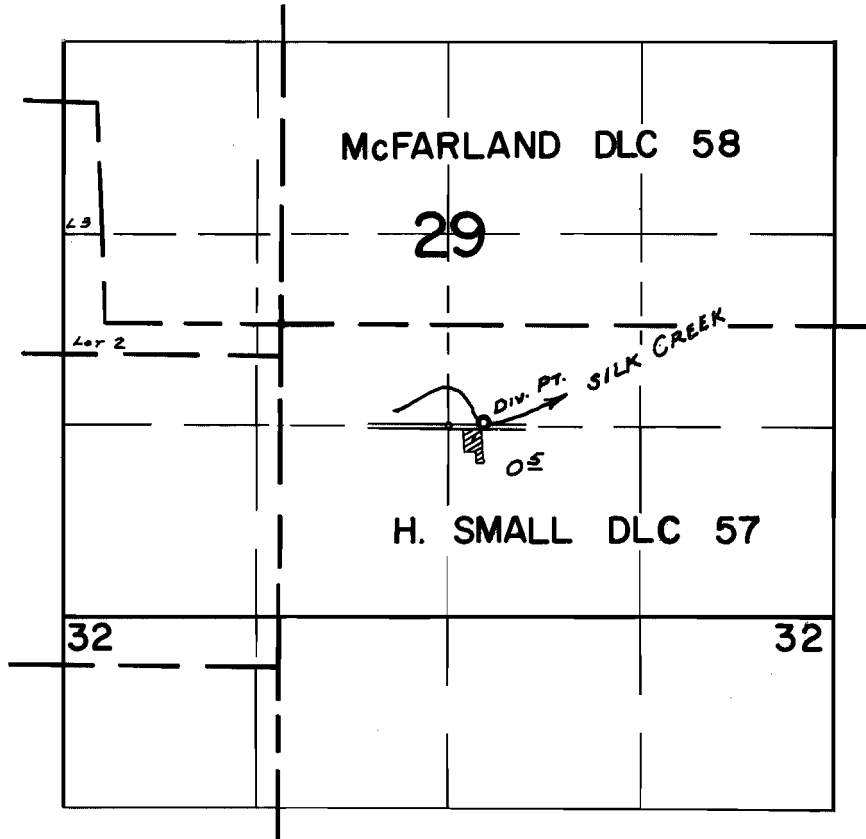

*DIV. PT. LOCATED: 30' N. & 230' E FROM N.W. COR. SW & SE 1/4 SEC. 29*

**FINAL PROOF SURVEY**  
UNDER

Application No. 43989 Permit No. 32886  
IN NAME OF

JOHN P. WALKER

Surveyed APR. 29, 1969, by W. RUPPERT