

T.20S.R.3W.W.M.

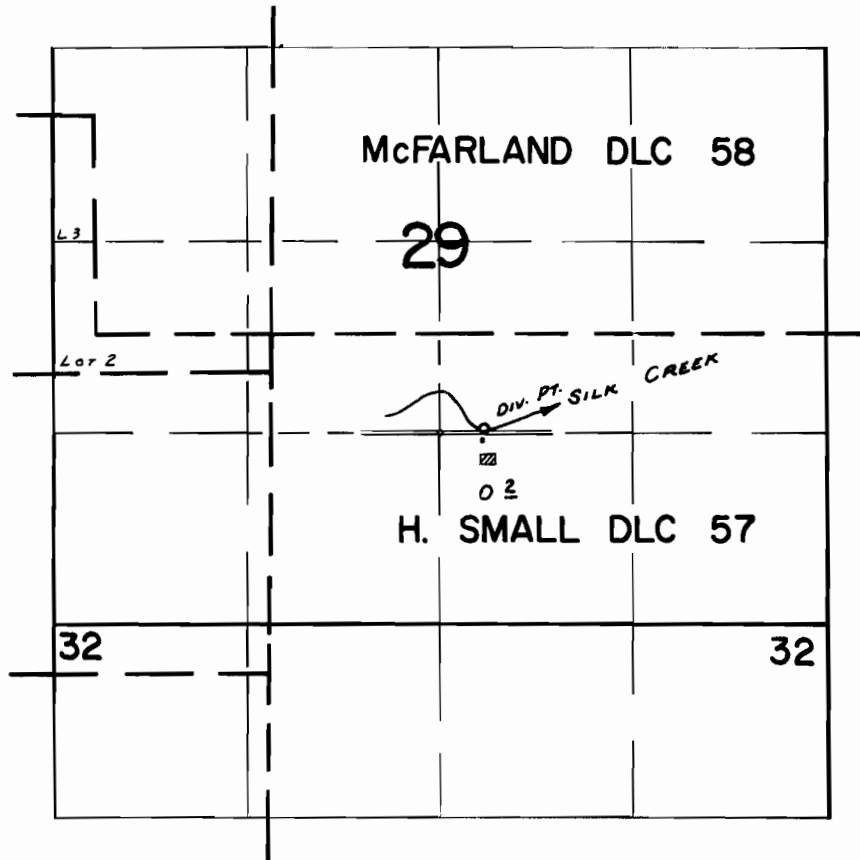

DIV. PT. LOCATED: 40' N. & 300' E. FROM N.W. COR. SW 1/4 SE 1/4 SEC. 29

**FINAL PROOF SURVEY**  
UNDER

Application No. 44/95 ... Permit No. 33020  
IN NAME OF

**CHARLES RONER & MARY E. RONER**

Surveyed . APR. 29 19.69, by . W. RUPPERT.