

THE DALLES RES
 CELILO PARK W
 Scale 1" =

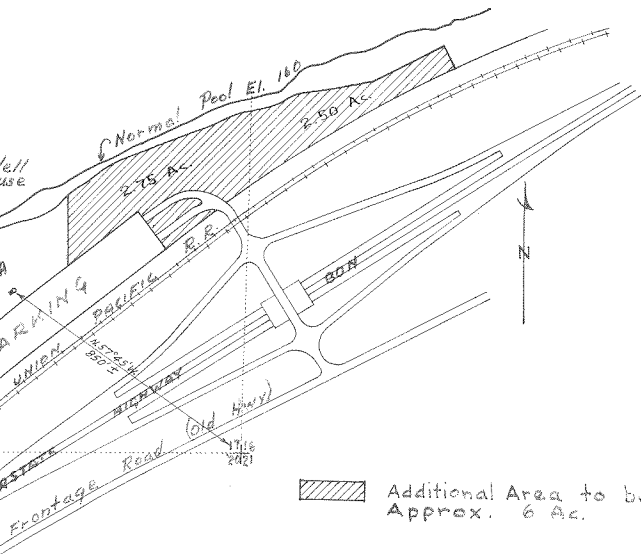

Additional Area to be Irrigated
Approx. 6 Ac.

THE DALLES RESERVOIR
MILLO PARK WELL (SUPP)
Scale 1" = 280

RECEIVED
NOV 17 1966
STATE ENGINEER
SALEM, OREGON

Application No. G-3708
Permit No. G-3508