

17th 2S,

Range 11 E.W.M.

5636

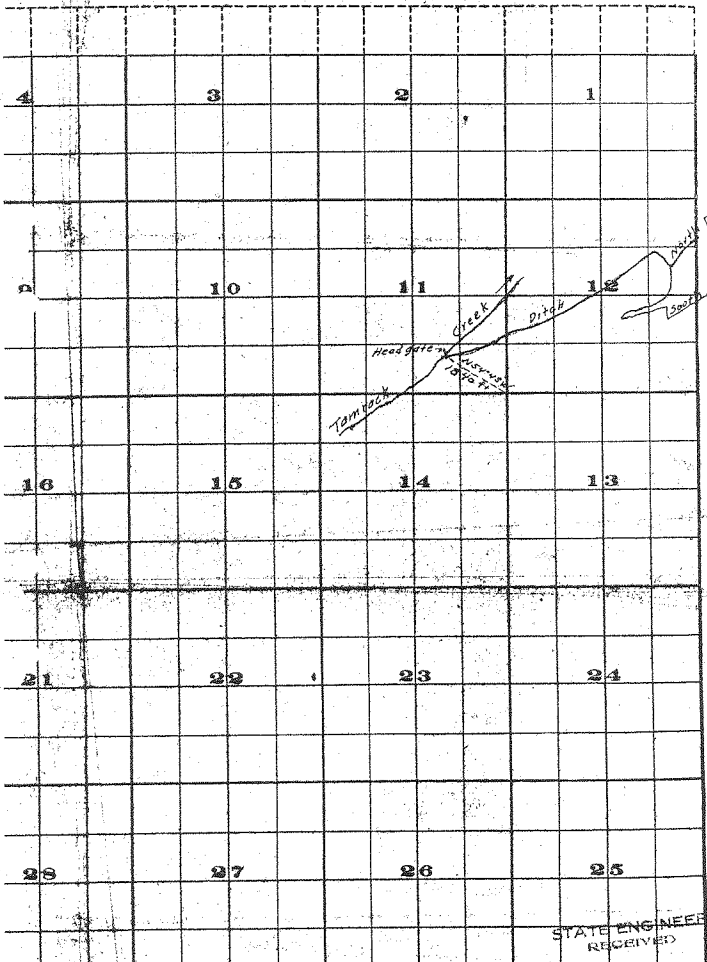

STATE ENGINEER RECEIVED

15 RE

5600

9

10

11

12

16

15

14

13

21

22

23

24

STATE ENGINEER
REGISTERED

SEP 9 1932

SALEM, OREGON

29

27

26

25

33

34

35

36

Note: This map is a preliminary application for permit
for 20 acres in S.W. 1/4, T. 11 E., Sec. 34.
The water to be obtained from Wolf Run Water Users
Association North Branch, Permit No 92-93 Application No. 59-442

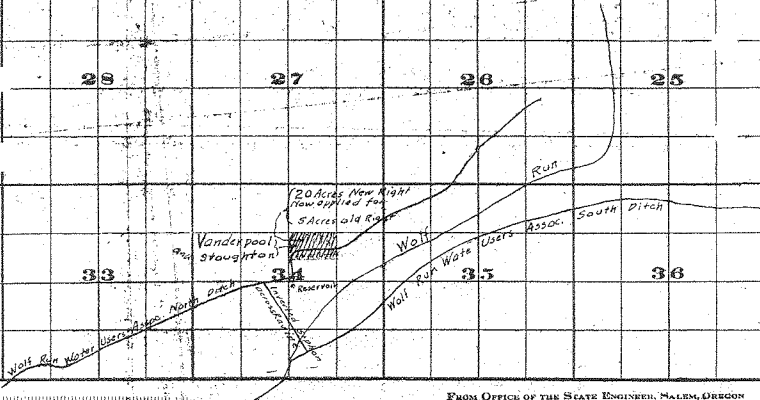

FROM OFFICE OF THE STATE ENGINEER, SALEM, OREGON