

T.32S.R.15W.W.M.

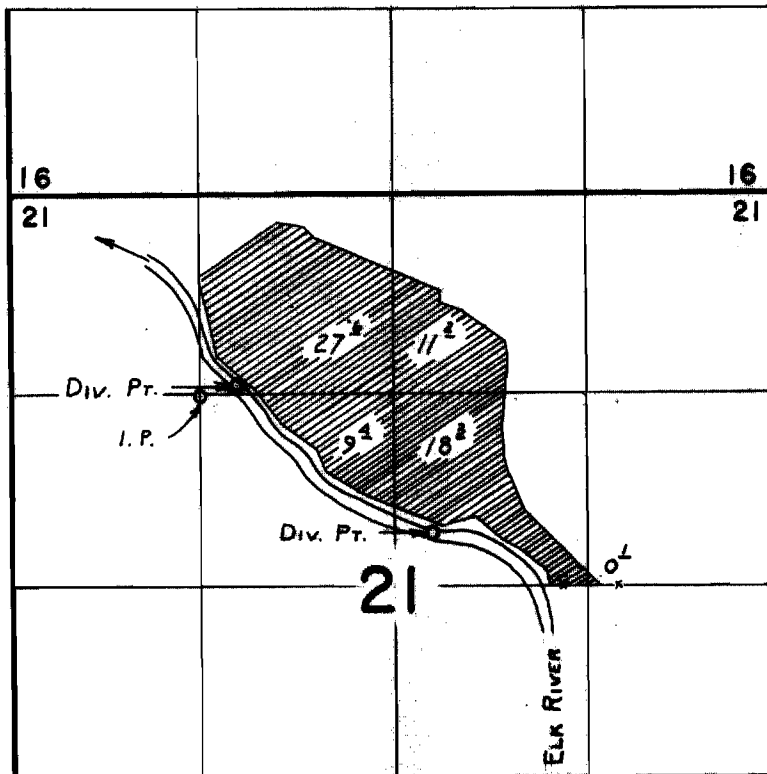

Div. Pts. located; 70 ft. N. & 260 ft. E.; 960 ft. S. & 1600 ft. E. from S.W. cor. NE & NW & Sec. 21.

FINAL PROOF SURVEY
UNDER

Application No. 39740 Permit No. 29631
IN NAME OF

HAZEL MCKENZIE

Surveyed May 14 1969, by L. E. Gould