

T.38S.R.14W.W.M.

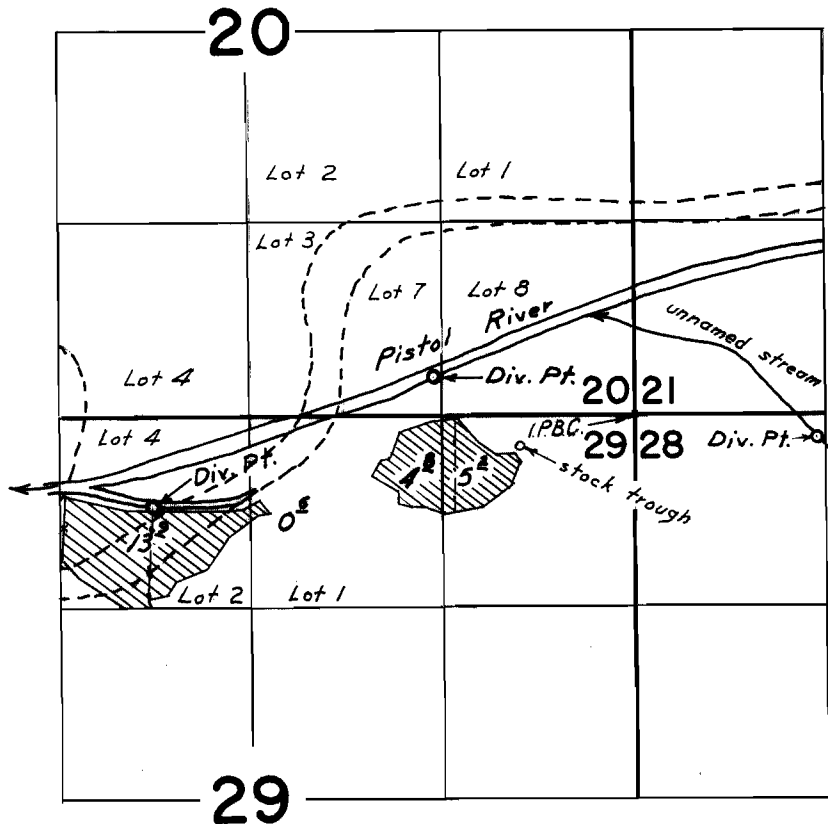

Div. Pt. located: 620 ft. S. & 3310 ft. W.; 270 ft. N. & 1370 ft. W.;
and 160 ft. S. & 1250 ft. E.; all from N.W. cor. Sec. 29.

FINAL PROOF SURVEY
UNDER

Application No. 39800 Permit No. 29830
IN NAME OF

HARVEY CROOK

Surveyed Aug. 27, 1969, by L. E. Gould