

T.7S.R.4W.W.M.

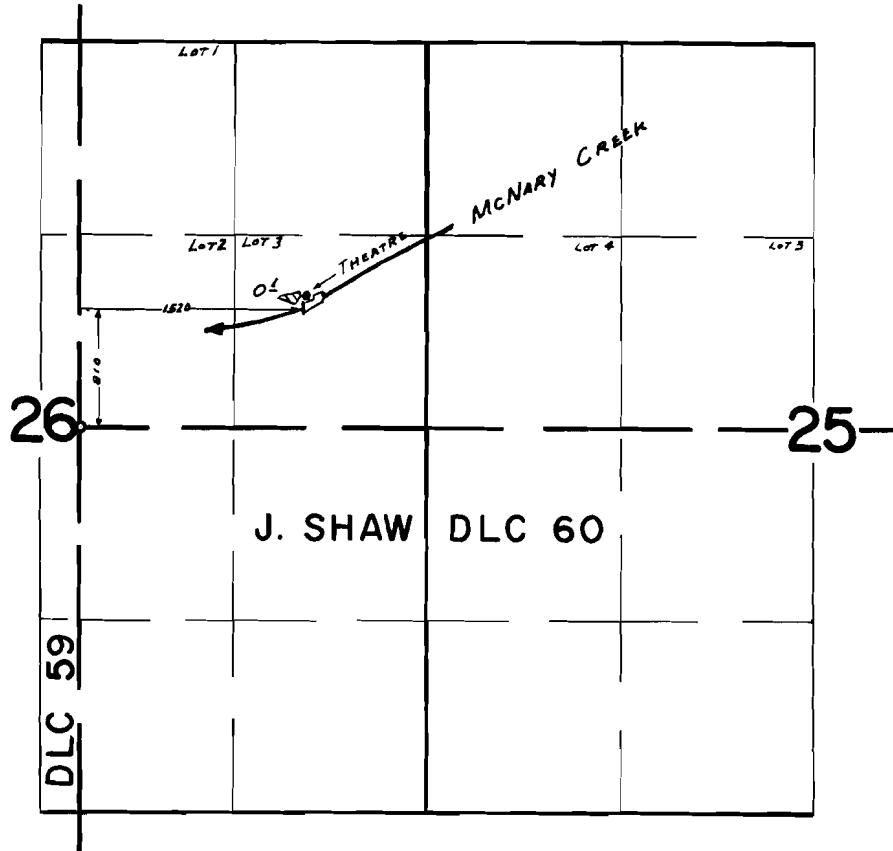

FINAL PROOF SURVEY
UNDER

R-38875 *R-3419*
Application No. *38876* Permit No. *28951*
IN NAME OF
AL J. LAUE
PRESIDENT, THE PENTACLE THEATRE, INC.

Surveyed *Nov. 24* 1969, by *D. BUELL*