

# T.3N.R.28E.W.M.

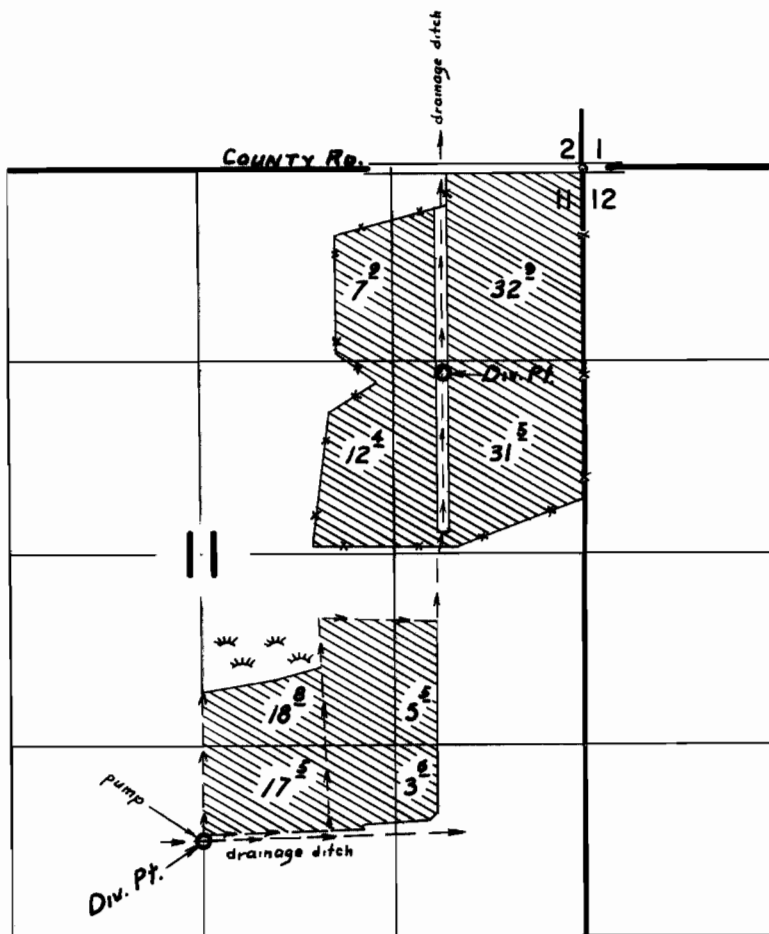

Div. Pts. located: 1410 ft. S. & 970 ft. W; and 4610 ft. S. & 2630 ft. W; both from NE. cor. Sec. 11

## FINAL PROOF SURVEY UNDER

Application No. 37613 38765 Permit No. 28053 28936  
IN NAME OF

JOHN M. CORREA

Surveyed Jul. 10, 1969, by L. E. Gould