

T.14S. R.15E.W.M.

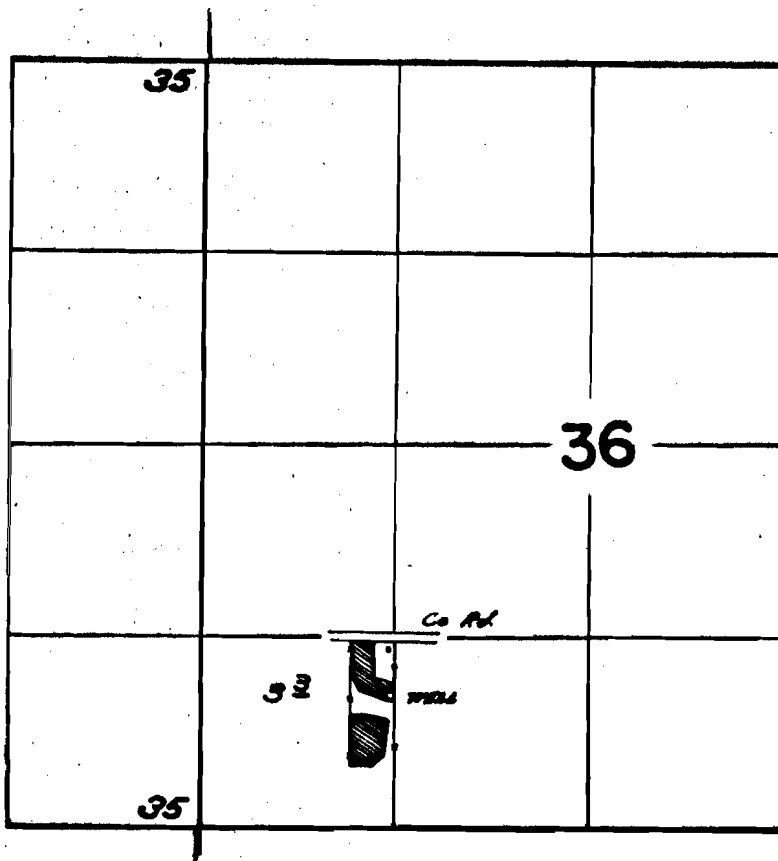

WELL LOCATED 100 FT. S. & 50 FT. W. FROM N.E. CORNER
SW 1/4 SW 1/4 SECTION 36

FINAL PROOF SURVEY UNDER

Application No. *G-5165*. Permit No. *G-2978*
IN NAME OF

..... LONNIE R. POWELL

Surveyed June 13 1968, by *R. G. Foy*