

T.20S.R.3W.W.M.

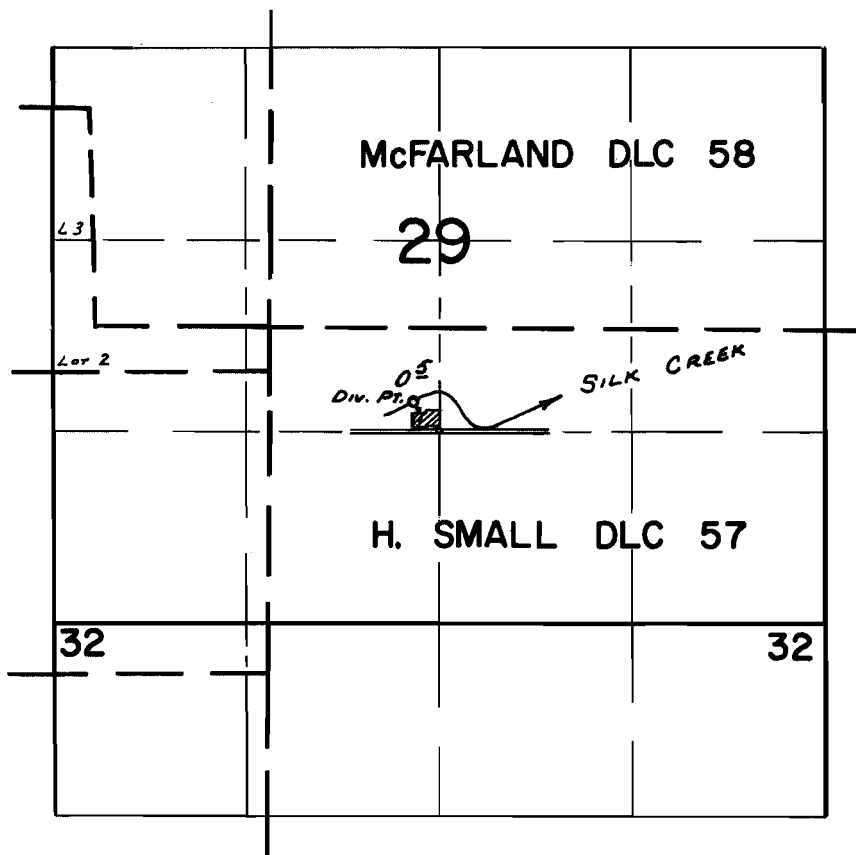

DIV. PT. LOCATED: 210' N. & 180' W. FROM N.W. COR. SW 1/4 SE 1/4 SEC. 29

FINAL PROOF SURVEY
UNDER

Application No. 44233 Permit No. 33040
IN NAME OF

WILLIAM L. RONER & EILEEN RONER

Surveyed APR. 29, 1969, by W. RUPPERT