

T.7S.R.5W.W.M.

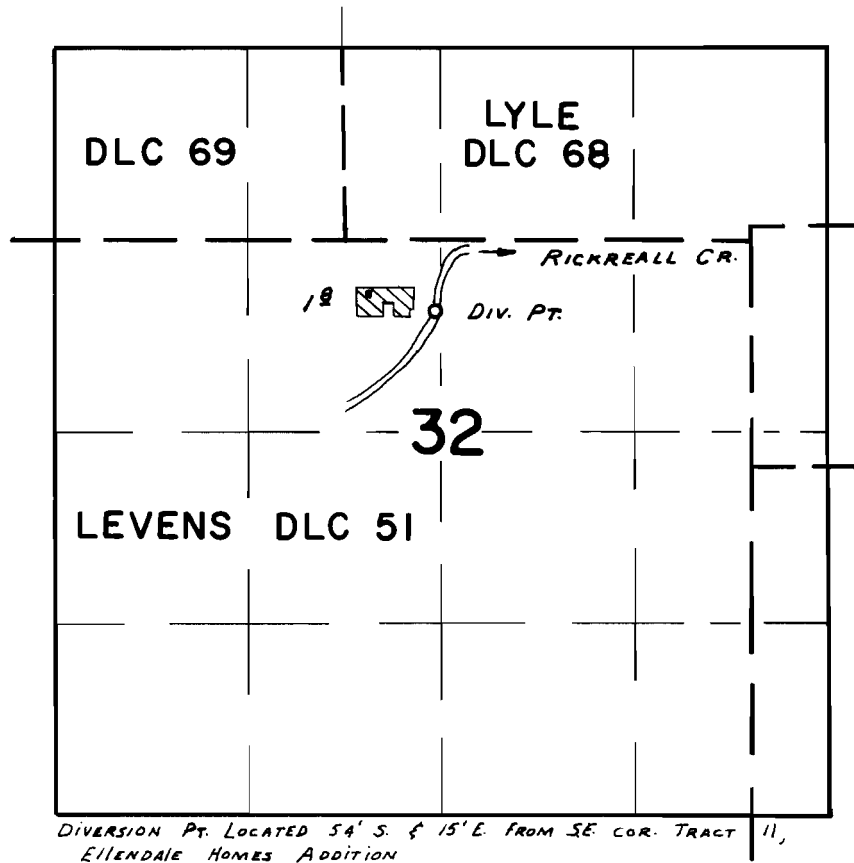

FINAL PROOF SURVEY UNDER

Application No. 42538 . Permit No. 31792 . . .
IN NAME OF

VICTOR R. AND PEARL E. BOYDSTON

Surveyed APR. 9 1969, by D. BUELL

1

Boydston, Victor R & Pearl &

75 328D-200
328D75-200

OFFICIAL RECORD OF DESCRIPTIONS OF REAL PROPERTIES

OFFICE OF COUNTY ASSESSOR, POLK COUNTY, OREGON

Code# 2-1

Dallas

YEAR	TAX LOT NO. 200	LOT or SEC. TT 11	BLK. or TNSHP.	Ellendale Homes		DEED REC.		ACRES REMAINING
				ADDITION OR S. RANGE	W.W.M.	VOL.	PAGE	
	BEARING	DISTANCE	BEARING REFERENCE OR LEGAL SUBDIVISION					
			Tract 11, Ellendale Homes Addition to Dallas.			125	355	
			V# F1802	9/3/79	DC pt	140	890	--
			TLC	10/22/79	p-o-a pt	141	726	--
			V# G1963	10/7/80	WD	146	1338	--
			V# J 399	6/20/83	WD	171	422	--
			TLC	8/16/84	ease	179	1520	--
			TLC	1/30/85	p-o-a pt	180	1921	--
			V# L 911	6/14/85	WD	187	603	--
			V#42339 Annex to the Polk Soil & Water Conserv Dist for 1988-89	(no code chg) 3/16/88	DOR 27-138-85			---
			V# 48118 acreage correction	12/5/91	per cb			1.25

NAME LEDGER

07 5 3280 00200 0201

	PC	BC	INSTRUMENT	ACRES
OWNER BOYDSTON, VICTOR R & PEARL E				
P O BOX 292	101			-----
DALLAS OR 97338				
OWNER BOYDSTON, PEARL E			V# F1802 140/890	--
OWNER WILLMARTH, KENNETH M & JENNESS B			V# G1963 146/1338	--
OWNER KROMER, DAVID A & MYRA J			V# J 759 171/422	--
OWNER HEFFNER, GERALD N & VICTORIA P			V# 911 187/603	--
acreage correction +1.25 acs for 1992 v#48118			per cb	1.25

SEE PROPERTY HISTORY FILE

1					N	5000.000,	E 10000.000
TRA	NW	90.0000	528.500				
2					N	5000.000,	E 9471.500
TRA	NE	0.0230	100.000				
3					N	5100.000,	E 9471.573
TRA	SE	90.0000	560.300				
4					N	5100.000,	E 10031.873
4					N	5100.000,	E 10031.873
INV	SW	17.4043	104.956				
1					N	5000.000,	E 10000.000

AREA = 54440.0 S.F., 1.250 ACRES

AREA = 0.0 S.F., 0.000 ACRES

INV	NE	0.0000	0.000				
1					N	5000.000,	E 10000.000
INV	SW	90.0000	528.500				
2					N	5000.000,	E 9471.500
INV	NE	0.0230	100.000				
3					N	5100.000,	E 9471.573
INV	NE	90.0000	560.300				
4					N	5100.000,	E 10031.873
INV	SW	17.4043	104.956				
1					N	5000.000,	E 10000.000

AREA = 54440.0 S.F., 1.250 ACRES

SAVED COORDINATE FILE NAMED 200BD.CCC

CC-SURV output, date: 10-30-1991, time: 1:00:28 PM FIL
 PLOT SCALE: 1 inch = 100 feet
 NORTH IS UP THE PAGE

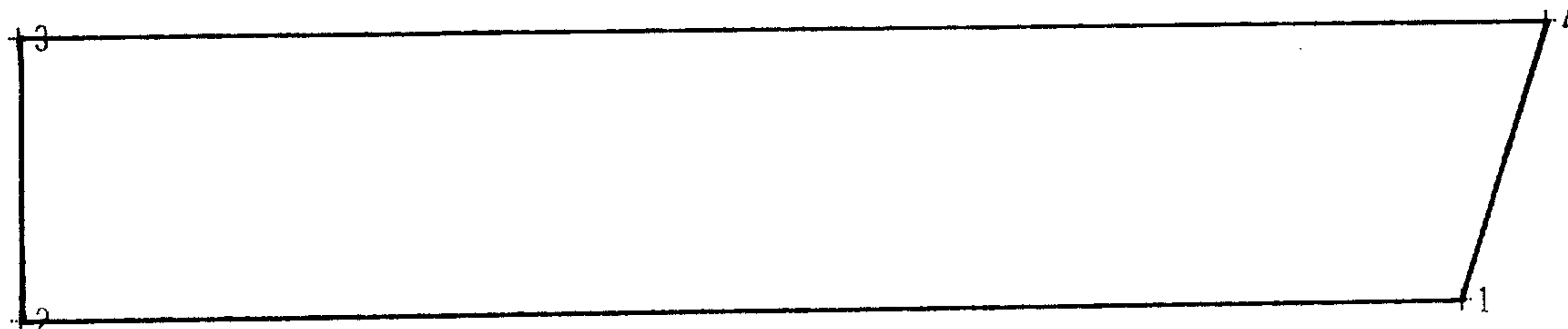

POINTS OFF PAPER: NONE

Baydston, Victor Ray & Pearl

OFFICIAL RECORD OF DESCRIPTIONS OF REAL PROPERTIES

75 328D-306

OFFICE OF COUNTY ASSESSOR, POLK COUNTY, OREGON

Dallas

Code# 2-1

328D75-300

YEAR	TAX LOT NO.	LOT or SEC.	BLK. or TNSHP.	ADDITION OR S. RANGE	W.W.M.	DEED REC.		ACRES REMAINING	
						VOL.	PAGE		
300		TT 12							
				Tract 12, Ellendale Homes Addition to Dallas.			131	557	
				(19638 CC)	8/17/71 B&S		14	973	
				V# F1803	9/3/79 DC pt		140	890	--
				TLC	10/22/79 p-o-a pt		141	726	--
				V#G1241	7/2/80	PR6352			--
				V# G1241	7/2/80 cont		148	1362	--
				V# G2139	10/20/80 cont		151	1068	--
				V# G2255	12/3/80 closed	PR 6352			--
				V# H1757	12/21/81 WD		159	2083	-
				V# H1757	12/21/81 WD		159	2084	-
				V# H1757	12/21/81 WD		159	2085	-
				TLC	8/16/84 ease		179	1519	--
				V# L 2006	10/30/85 wd		189	1069	--
				V#42339 Annex to the Polk Soil & Water Conserv Dist for 1988-89 (no code chg) 3/16/88 DOR 27-138-85					---
				V#48119 acreage correction +1.18 acs					
					12/5/91 per cb				1.18
				V#U 537	3/23/94 wd		281	830	

NAME LEDGER

07 5 3280 00300 0201

	PC	BC	INSTRUMENT	ACRES
OWNER BOYDSTON, VICTOR R & PEARL E				
P O BOX 292	101			-----
DALLAS OR 97338				
OWNER BOYDSTON, PEARL E	V#	F1803	140/890	--
OWNER BOYDSTON, PEARL E, EST				
AGENT BOYDSTON, JAMES, P/REP	V#	G1241	PR6352	--
OWNER BOYDSTON, PEARL E, EST				
AGENT BOYDSTON, JAMES, P/REP				
AGENT LYMAN, STANN R & LAVERNE K, AGT	V#	G1241	148/1362	--
OWNER BOYDSTON, PEARL E, EST				
AGENT BOYDSTON, JAMES, P/REP				
AGENT LYMAN, STANN R & LAVERNE K, AGT #1				
AGENT WILLMARTH, KENNETH M & WILLMARTH, JENNESS B, AGT #2	V#	G2139	151/1068	--
OWNER BOYDSTON, JAMES R				
AGENT LYMAN, STANN R & LAVERNE K, AGT #1				
AGENT WILLMARTH, KENNETH M & WILLMARTH, JENNESS B, AGT #2	V#	G2255	PR6352	-
OWNER LYMAN, STANN R & LAVERNE K				
AGENT WILLMARTH, KENNETH M & WILLMARTH, JENNESS B, AGT	V#	H1757	159/2083	-
OWNER WILLMARTH, KENNETH M & JENNESS B	V#	H1757	159/2084	-
OWNER FOWLER, DOROTHY M	V#	H1757	159/2085	--
OWNER WILLMARTH, KENNETH M & JENNESS B	V#	L 2006	189/1069	--
acreage correction +1.18 acs fo r1992	V#48119		per cb	1.18
OWNER PHILLIPS, ELVIN E & NADINE E	V#	U 537	281/830	

SEE PROPERTY HISTORY FILE

CC-SURV output, date: 10-30-1991, time: 12:57:37 PM, FI

1				N	5000.000	E	10000.000
TRA	NW	90.0000	502.200				
2				N	5000.000	E	9497.800
TRA	NE	0.0230	100.000				
3				N	5100.000	E	9497.873
TRA	SE	90.0000	528.500				
4				N	5100.000	E	10026.373
4				N	5100.000	E	10026.373
INV	SW	14.4627	103.419				
1				N	5000.000	E	10000.000

AREA = 51535.0 S.F., 1.183 ACRES

AREA = 0.0 S.F., 0.000 ACRES

1				N	5000.000	E	10000.000
INV	SW	90.0000	502.200				
2				N	5000.000	E	9497.800
INV	NE	0.0230	100.000				
3				N	5100.000	E	9497.873
INV	NE	90.0000	528.500				
4				N	5100.000	E	10026.373
INV	SW	14.4627	103.419				
1				N	5000.000	E	10000.000

AREA = 51535.0 S.F., 1.183 ACRES

SAVED COORDINATE FILE NAMED 300BD.CCC

CC-SURV output, date: 10-30-1991, time: 12:58:56 PM FI
 PLOT SCALE: 1 inch = 100 feet
 NORTH IS UP THE PAGE

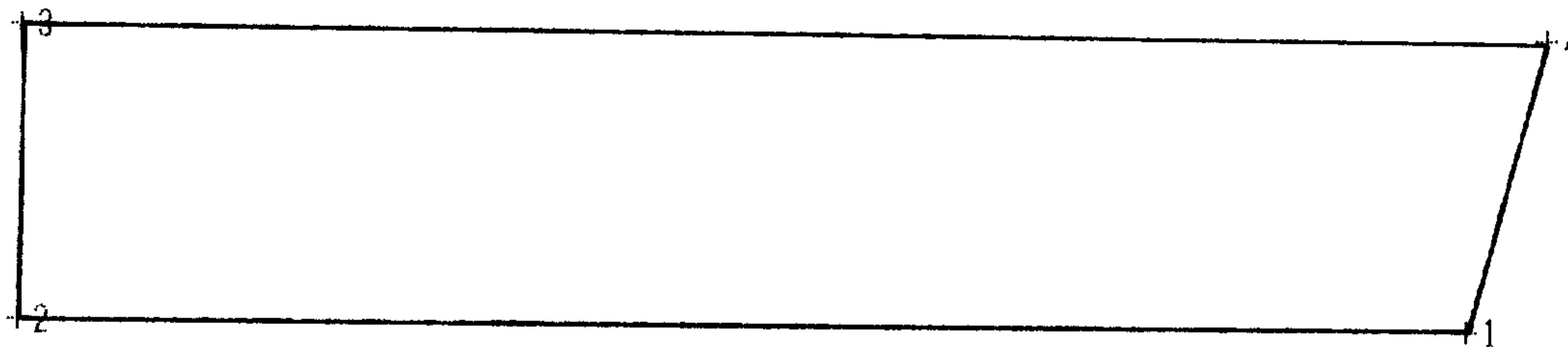

POINTS OFF PAPER: NONE