

T. 29 S. R. 12 W. W.M.

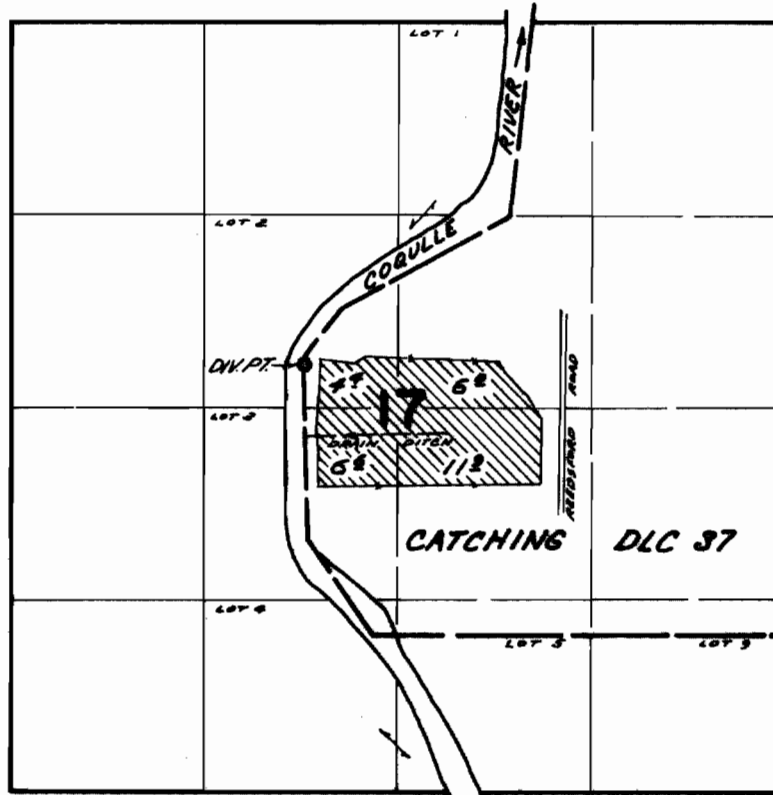

DIV. PT. LOCATED 1860' N & 480' W. FROM SW COR. CATCHING
DLC 37

FINAL PROOF SURVEY
UNDER

Application No. 92663 Permit No. 31884
IN NAME OF

JAMES CARLOCK

Surveyed SEP 11 1969, by D. BULL