

T. 30 S. R. 4 W. W. M.

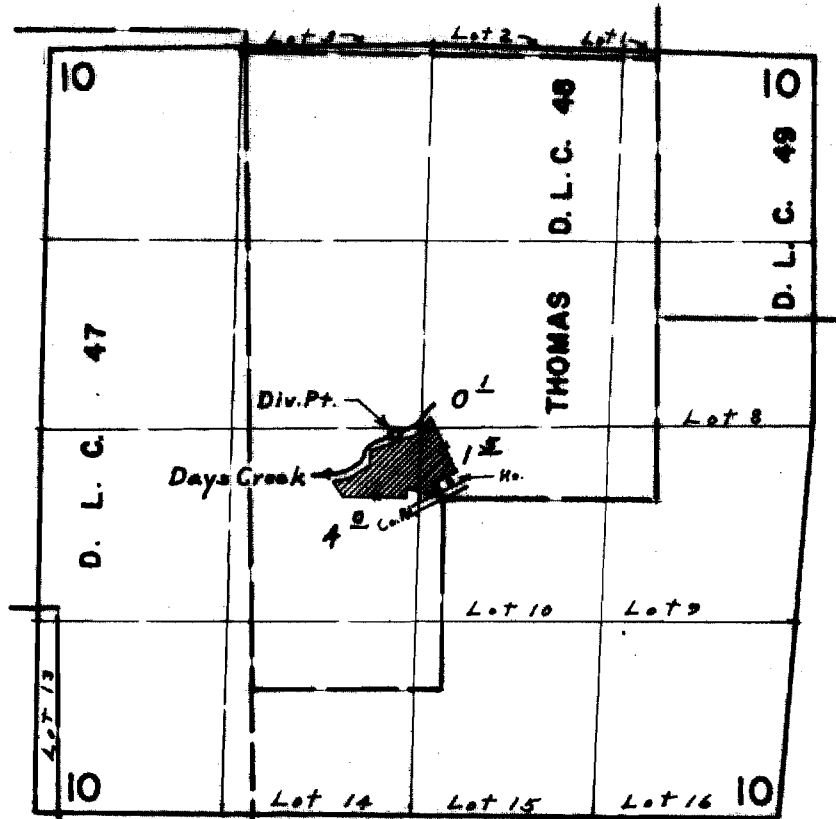

Div. Pt. located 440' N. & 320' W. from S. Int. Cor. Thomas D.L.C. 48

FINAL PROOF SURVEY UNDER

Application No. 42119 Permit No. 31505
IN NAME OF
ROY P. DUNCAN

Surveyed June 25, 1969, by L. E. Gould