

T. 30 S. R. 11 W. W. M.

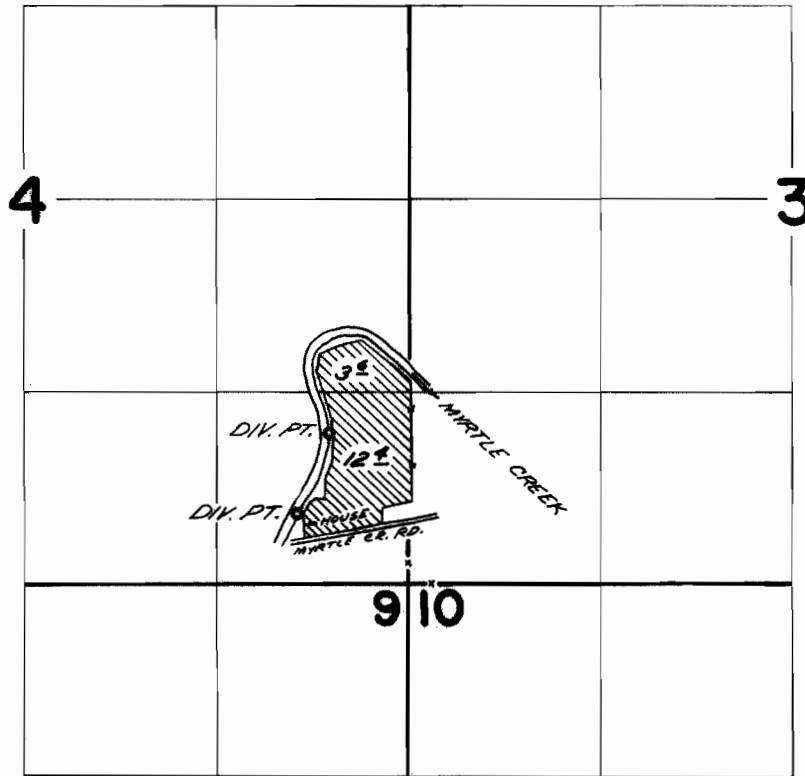

DIV. PTS. LOCATED; 1030' N. & 570' W.; 980' N. & 770' W.; BOTH FROM SE COR. SEC. 4

FINAL PROOF SURVEY UNDER

Application No. 39679 Permit No. 29621
IN NAME OF

CHARLES T. HOUSTON

Surveyed SEP 9 1969, by D. BUELL