

T. 27 S. R. 7 W. W. M.

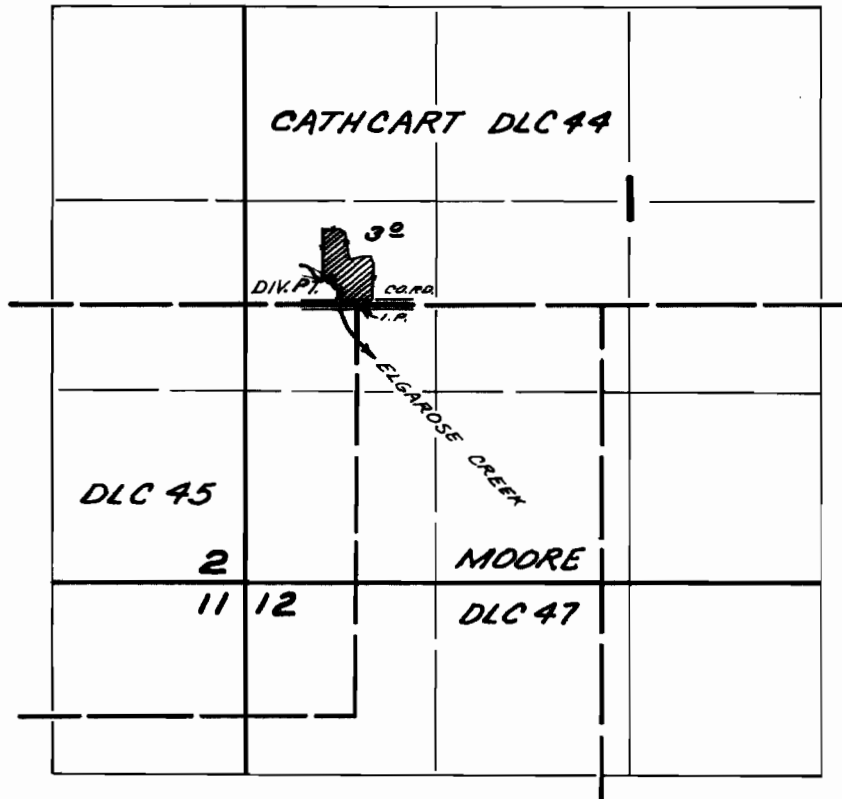

DIV. PT. LOCATED 170' N. & 180' W. FROM NW COR. MOORE DLC 47

FINAL PROOF SURVEY
UNDER

Application No. 42428 Permit No. 31747
IN NAME OF

ARTHUR AND BETTY ALLEN

Surveyed APR. 15, 1969, by D. BUELL