

T.IOS.R.2W.W.M.

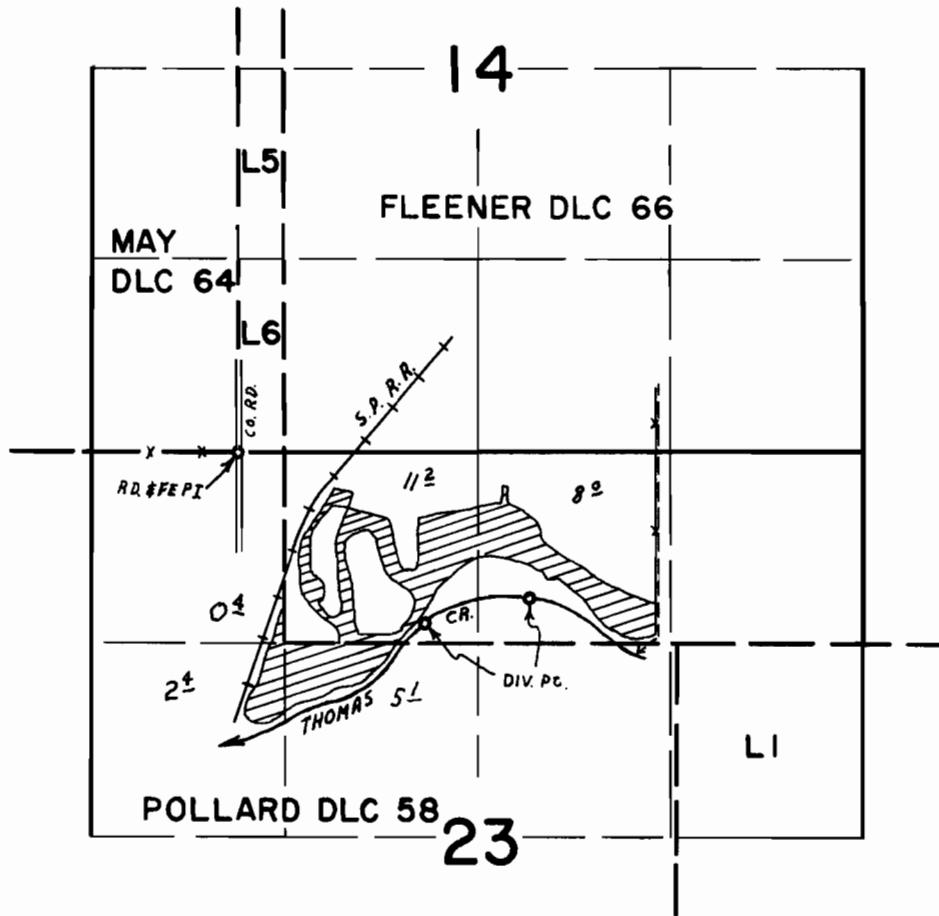

WEST DIV. PT. LOC. 1170' S. & 1260' E. FROM SE COR. MAY DLC 64
EAST DIV. PT. LOC. 1000' S. & 1980' E. FROM SE COR. MAY DLC 64

FINAL PROOF SURVEY UNDER

Application No. 41378 Permit No. 30910
IN NAME OF

CITIZENS VALLEY BANK

Surveyed JULY 29, 1970, by D. BUELL