

# T.15S.R.46E.W.M.

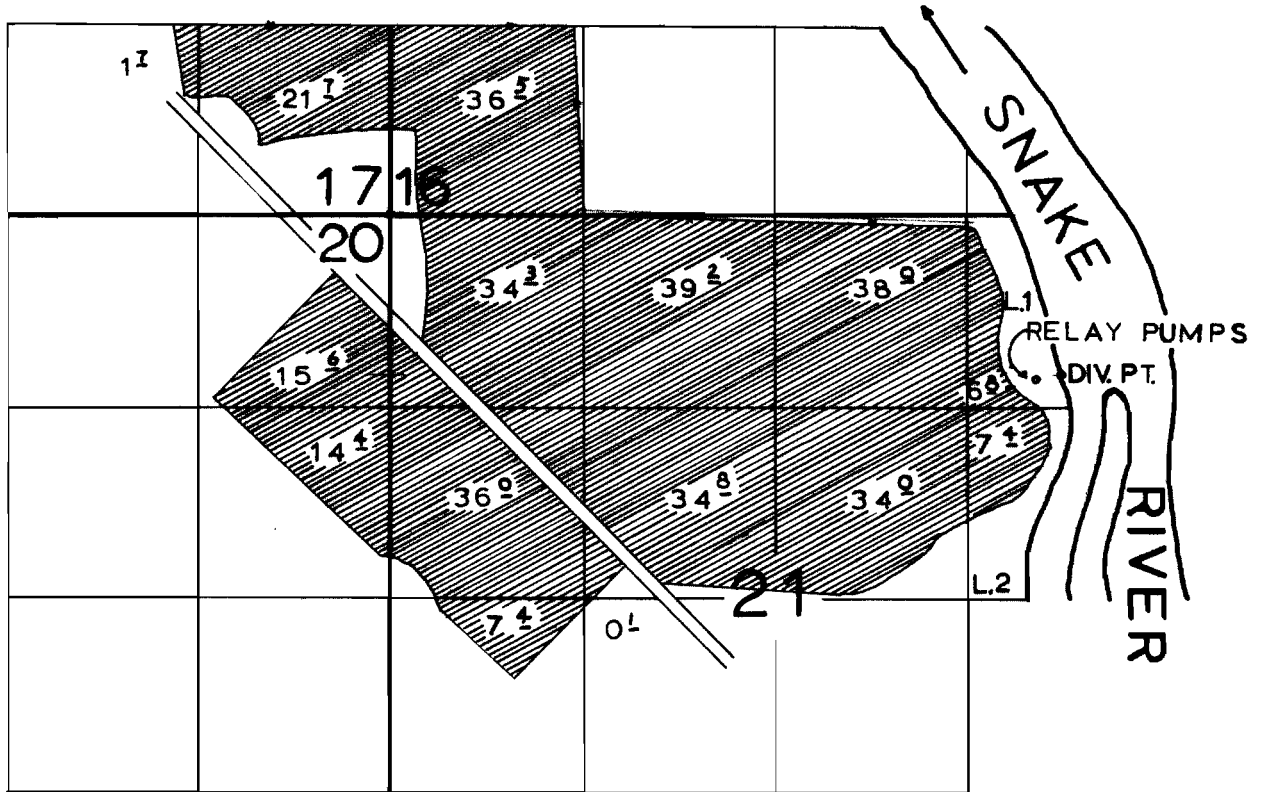

DIV. PT. IS 1100' S. & 4580' E. FROM NW COR. SEC. 21

## FINAL PROOF SURVEY UNDER

Application No. 41851 Permit No. 31319  
IN NAME OF

THEODORE N. BOKIDES

Surveyed SEPT. 18 1970, by ELFERING