

# T. 9 S. R. 4 W. W. M.

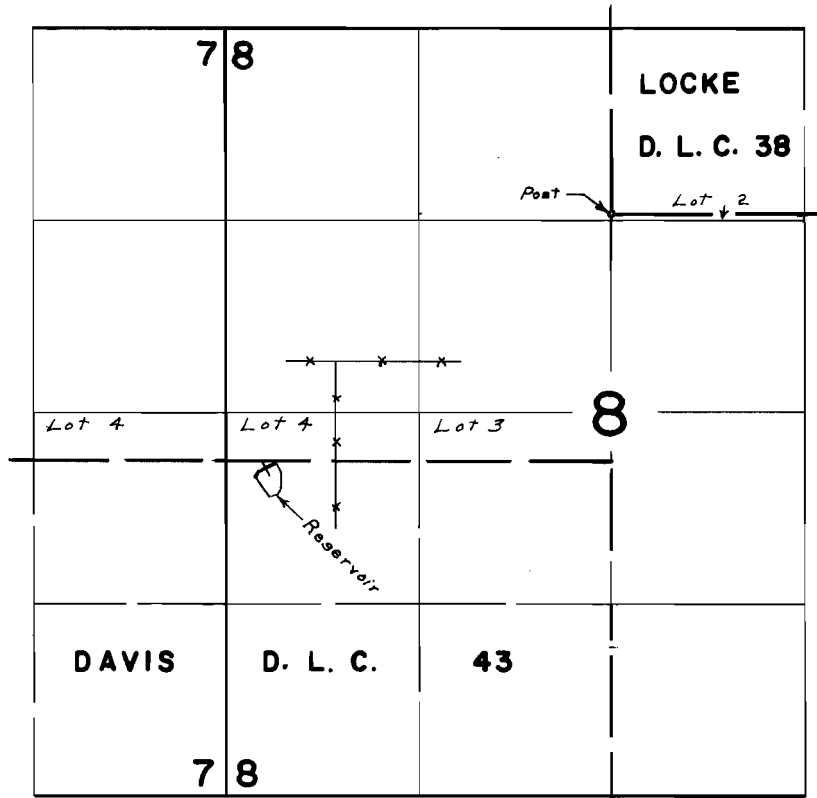

Div. Pt. located 1750' S. & 2360' W. from S.W. Cor. Locke D.L.C. 38

## FINAL PROOF SURVEY UNDER

Application No. R-43100 Permit No. R-4915...  
IN NAME OF

T. LEE DAVIS

Surveyed March 19, 1969, by L. E. Gould.