

T. 12 S. R. 6 W. W.M.

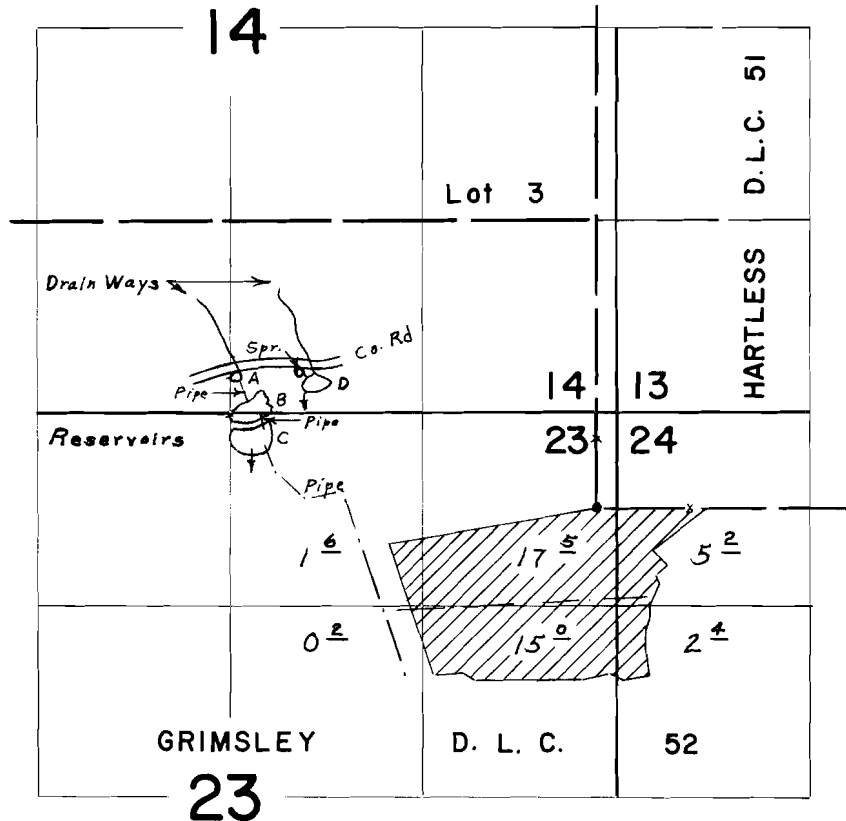

Div. Pts. located: A-870' N. & 2430' W., B-620' N. & 2280' W., C-370' N. & 2380' W., D-800' N. & 1980' W. all from S.W. Cor. Hartless DLC 51

FINAL PROOF SURVEY UNDER

R-43557 R- 5002
Application No. 43558 Permit No. 32576
IN NAME OF

FRANK A. NORDYKE

Surveyed Sept. 5, 1969, by L. E. Gould