

T. 35 S. R. 6 W. W. M.

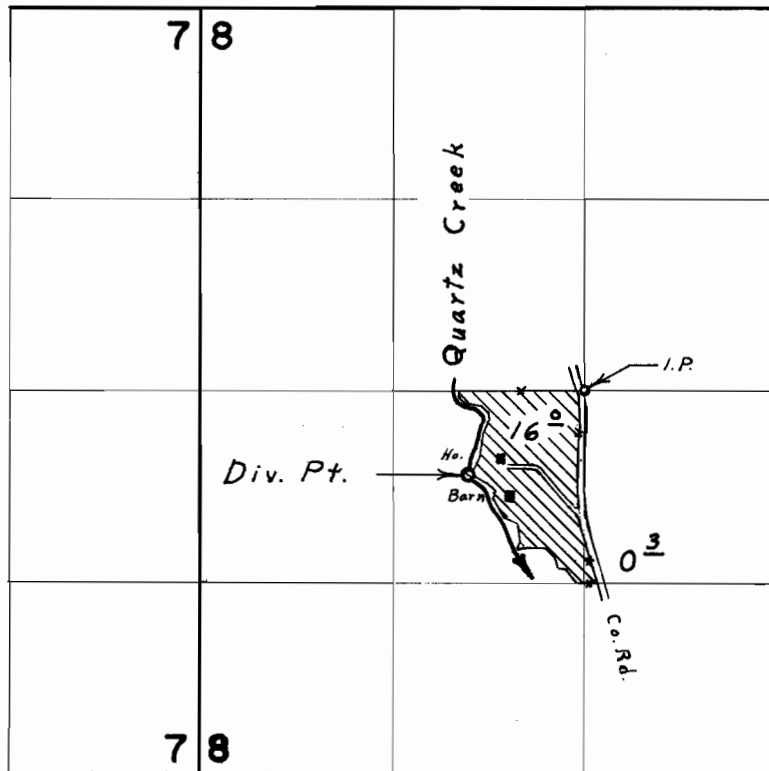

*Div. Pt. located 580' S. & 800' W. from Center Sec. 8*

FINAL PROOF SURVEY

UNDER

Application No. 41037 Permit No. 30635

IN NAME OF

**HAROLD A. WARDEN**

Surveyed April 15, 1970, by L. E. Gould