

T.11S.R.3W.W.M.

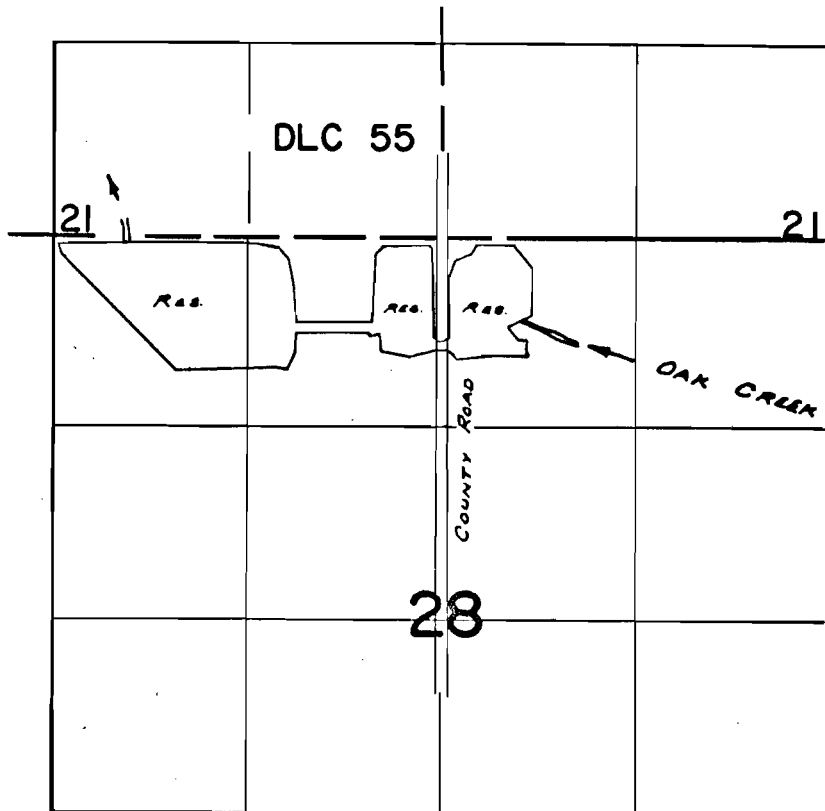

Div. Pt. Located: 50' S. & 2140' W. From N. 1/4 Cor. Sec. 28

FINAL PROOF SURVEY
UNDER

Application No. ⁴⁰⁴²⁶ *R-40801*. Permit No. ³⁰³⁷¹ *R-4569*.
IN NAME OF

.....**LINN COUNTY**.....

Surveyed *June 12, 1969*, by *W. RUPPERT*.....