

T.11S.R.3W.W.M.

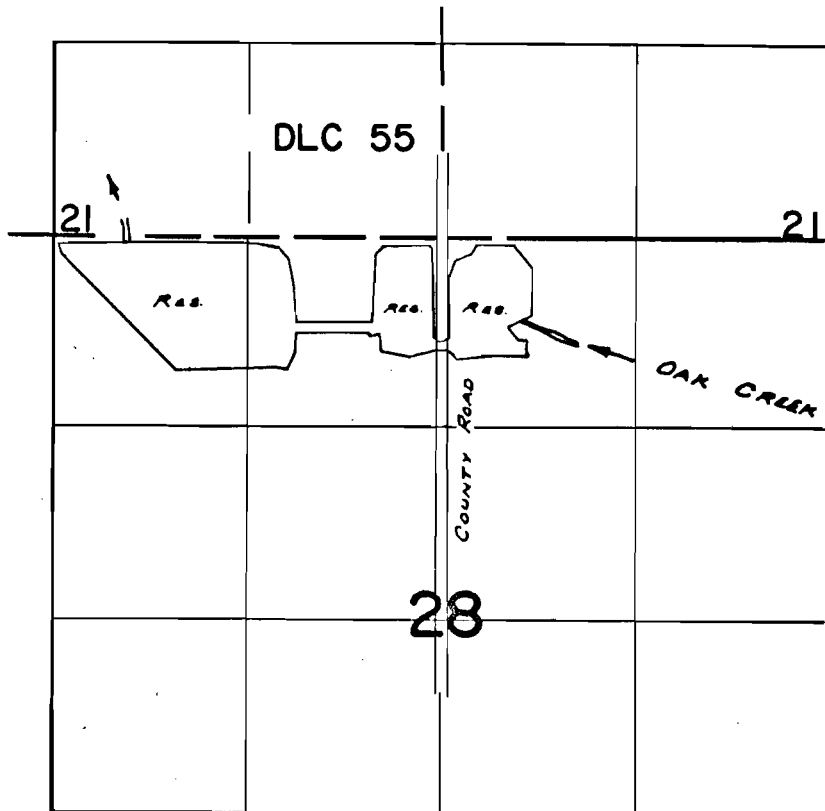

*Div. Pt. Located: 50' S. & 2140' W. From N. 1/4 Cor. Sec. 28*

**FINAL PROOF SURVEY**  
UNDER

Application No. <sup>40426</sup> *R-40801*. Permit No. <sup>30371</sup> *R-4569*.  
IN NAME OF

.....**LINN COUNTY**.....

Surveyed *June 12, 1969*, by *W. RUPPERT*.