

T.1&2S.R.2E.W.M.

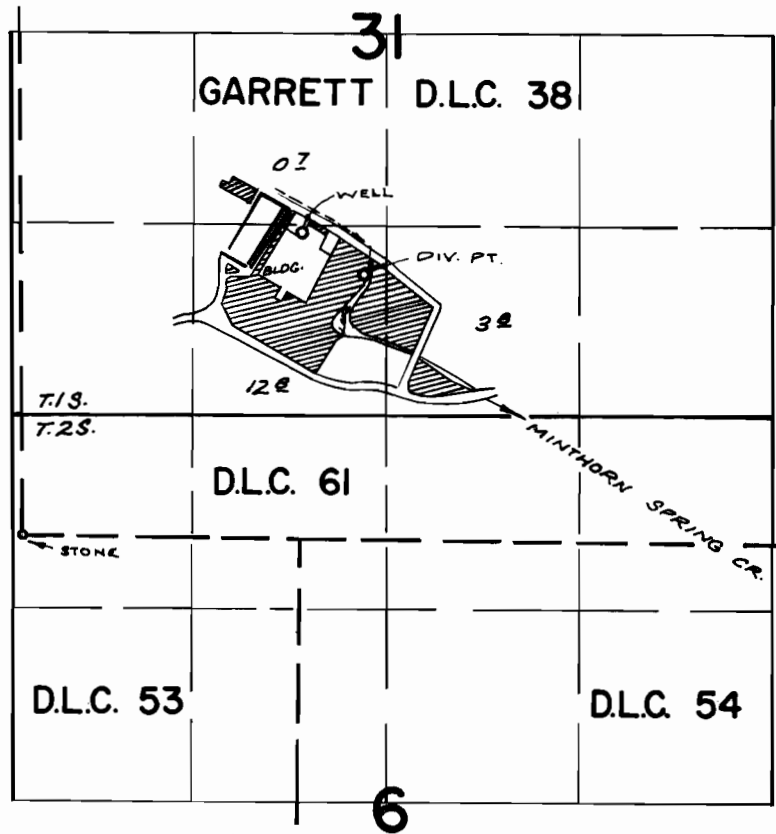

WELL LOC: 1900' E. & 2090' N. FROM S.W. COR. GARRETT D.L.C. 61
DIV. PT. LOC: 2340' E. & 1800' N. "

FINAL PROOF SURVEY UNDER

TRANSFER No. 0-54
Application No. ~~G-3235~~ ~~G-4547~~ Permit No. G-3041 G-4276
IN NAME OF

OMARK PROPERTIES, INC.

Surveyed Nov. 6, 1970, by L. E. GOULD.