

T. 29S. R. 11W. W.M.

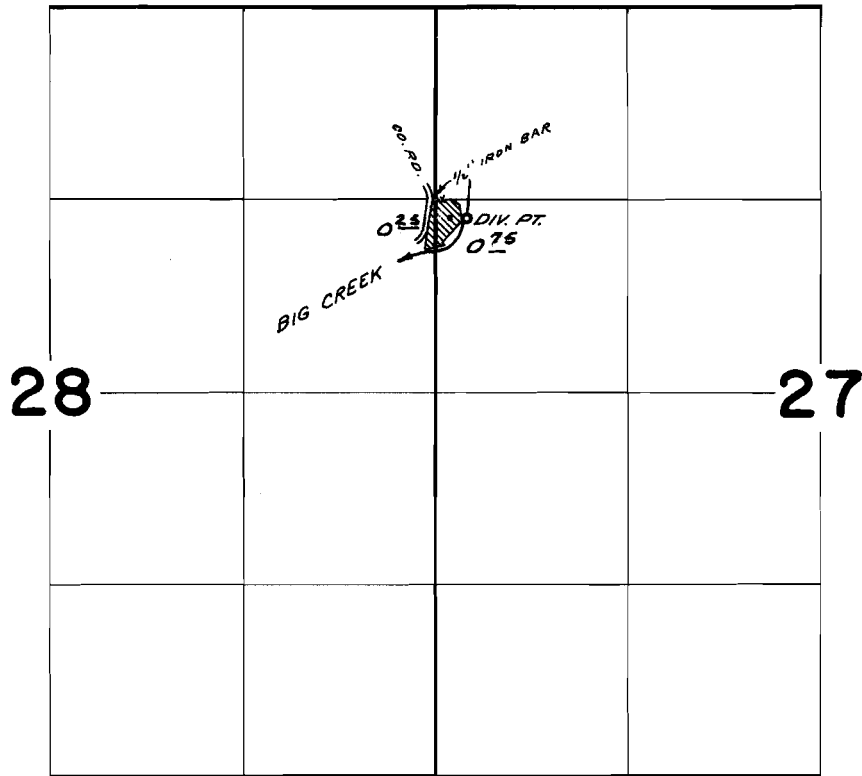

DIV. PT. LOCATED 130' S. AND 210' E. FROM NW COR. SW $\frac{1}{4}$ NW $\frac{1}{4}$, SEC. 27

FINAL PROOF SURVEY
UNDER

Application No. 40087 Permit No. 29872
IN NAME OF

WALLACE N. PARRISH

Surveyed SEP. 13 1969, by D. BUELL