

T. 9 S. R. 4 W. W.M.

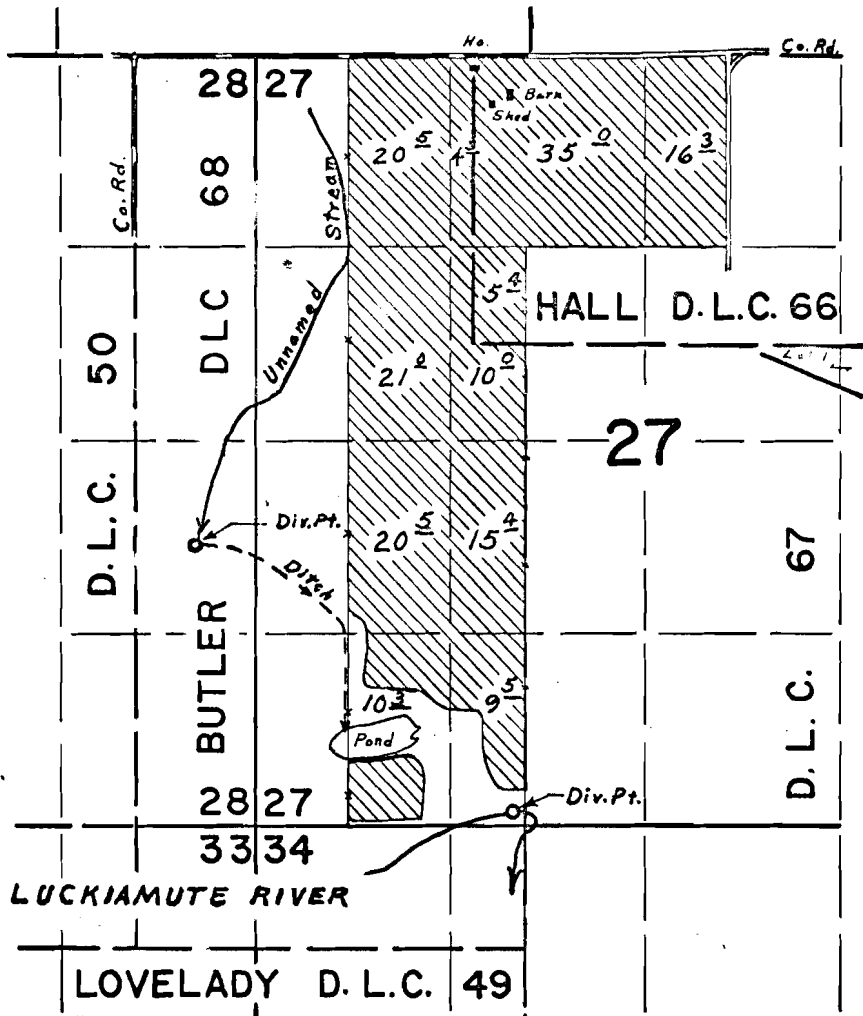

Div. Pts. located: 5160' S. & 2550' E. ; 3350' S. & 410' E.
Both From N.W. Cor. Butler D.L.C. 68

FINAL PROOF SURVEY UNDER

R-40177 R-4475
Application No. 40015 Permit No. 29802
IN NAME OF

IVAN NISLY

Nov. 2, 1970
Surveyed March 20, 1969, by L. E. Gould.