

T.34S.R.IV.W.M.

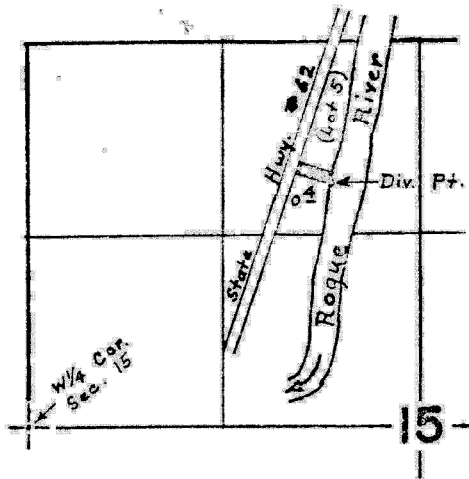

Div. Pt. 15 located 1680' N. and
2045' E. from W/4 Cor. Sec. 15.

FINAL PROOF SURVEY UNDER

Trans. No. D-131

Application No. _____ Permit No. _____

IN NAME OF

Dale & Margaret Davis

Surveyed 5/18 1971, by D.C. Hendrix