

# T.2S.R.3E.W.M.

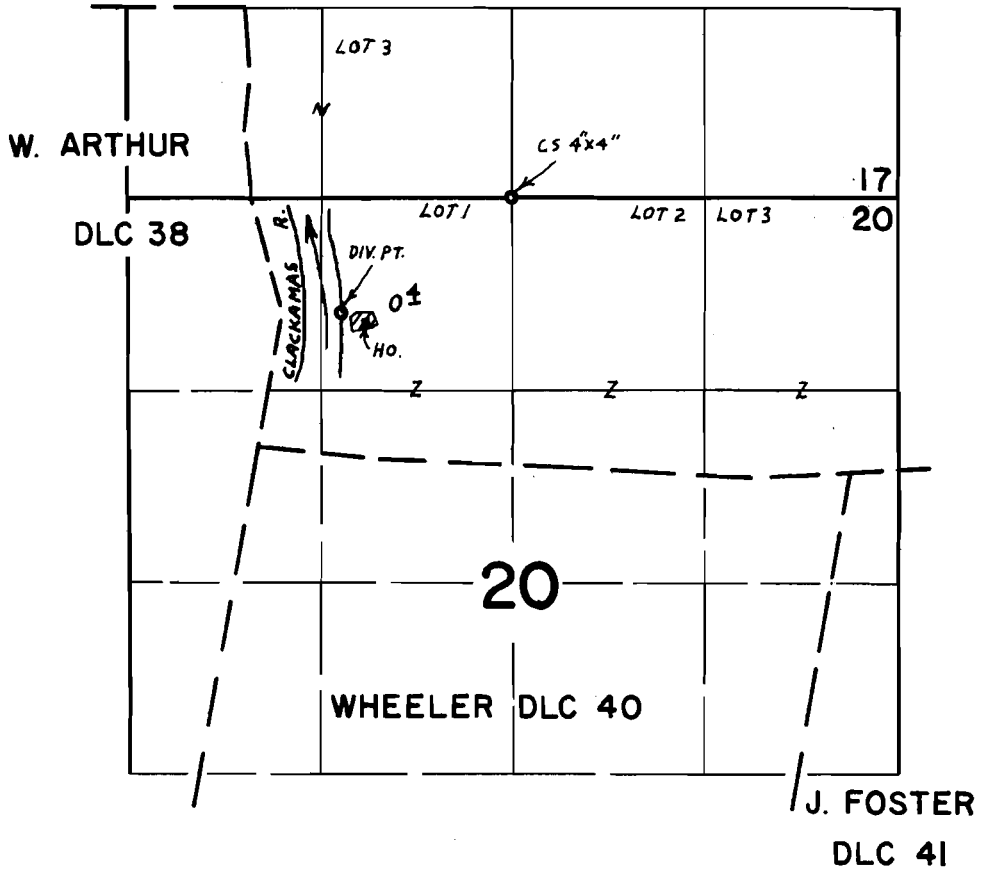

DIV. PT. LOC. 780'S. & 1170'W. FROM N. 1/4 COR. SEC. 20

## FINAL PROOF SURVEY

UNDER

Application No. 43880 Permit No. 32788

IN NAME OF

STANLEY L. LARSON

Surveyed SEPT. 30 19 70, by G. BACA