

T.37 & 38S.R.5W.W.M.

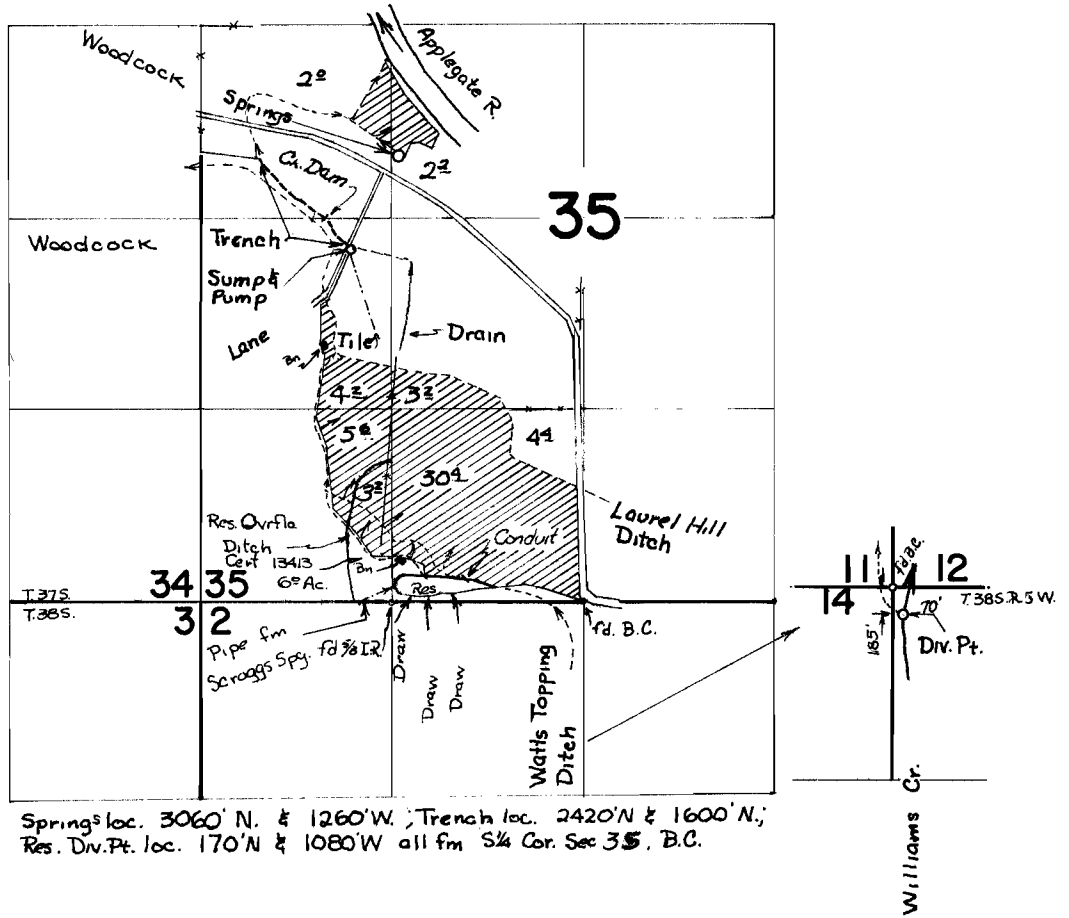

Spring^s loc. 3060' N. & 1260' W.; Trench loc. 2420' N. & 1600' N.;
 Res. Div. Pt. loc. 170' N. & 1080' W. all fm S 1/4 Cor. Sec 35, B.C.

FIELD SURVEY

R 38699 38700 R 3862 29162

LYLE WOODCOCK

14 APR 1970, by D. R. BUELL