

T.18S.R.2W.W.M.

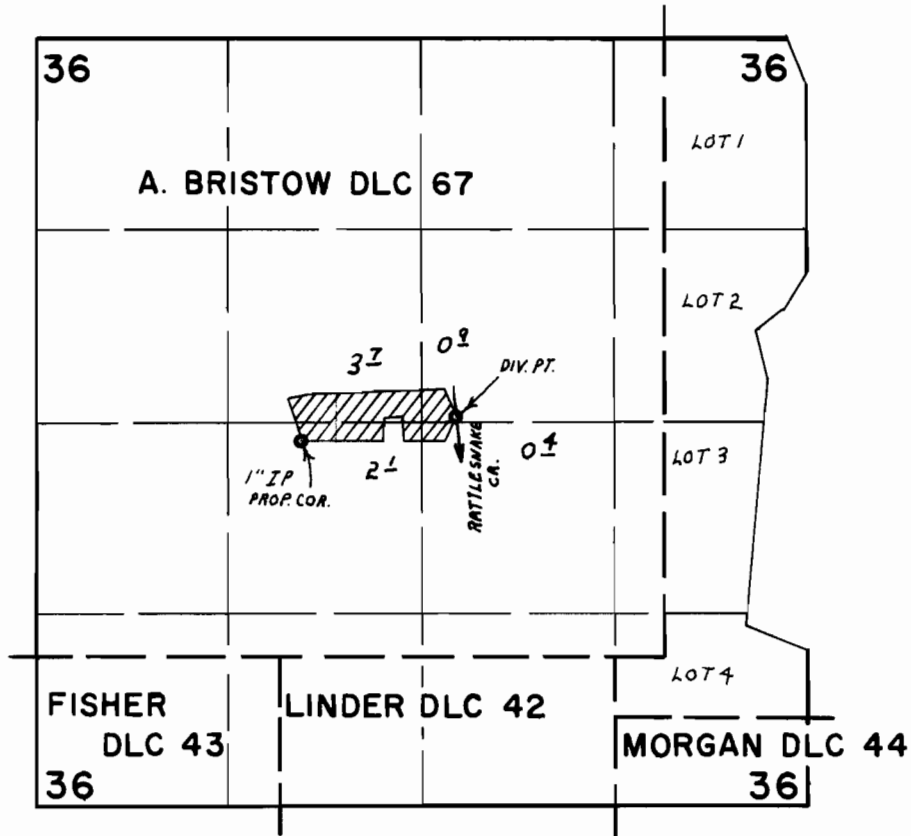

DIV. PT. LOC. 1650' N. & 1430' W. FROM SE COR. A. BRISTOW DLC 67

FINAL PROOF SURVEY

UNDER

ACTS OF CONGRESS, PUBLIC NO. 31864

IN NAME OF

WILLIAM A. PAIGE

Surveyed OCT. 9, 1970, by G. BACA