

T. 10S. R. 6W. W.M.

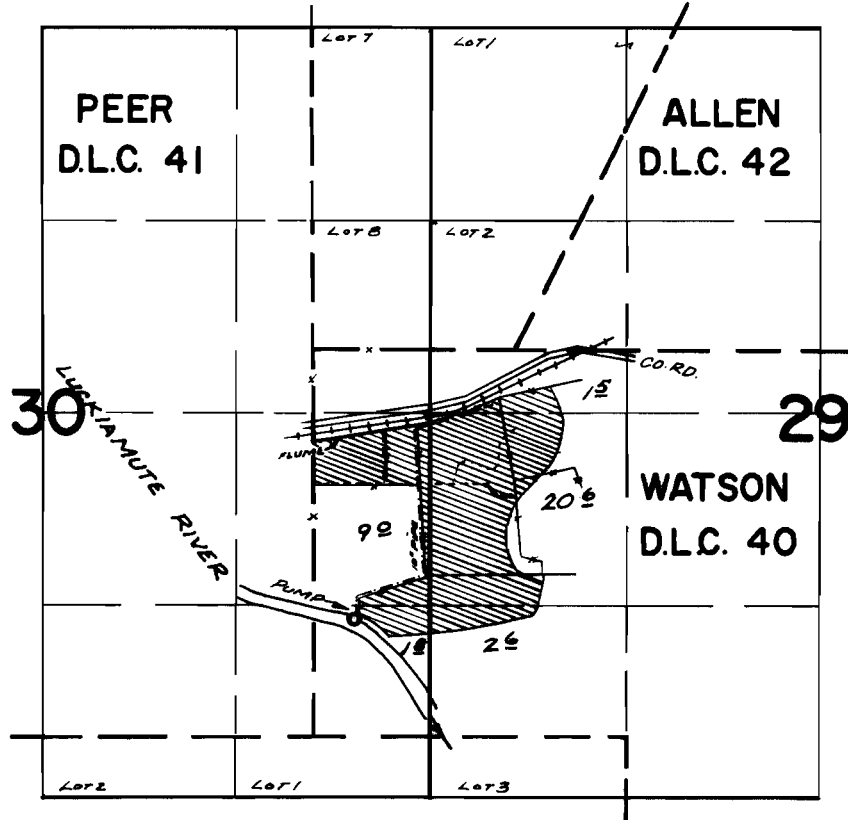

FINAL PROOF SURVEY  
UNDER

Application No. 14125 Permit No. 10203  
IN NAME OF

C. L. BUSH

Surveyed Aug. 31, 1942, by GEORGE NADERMAN  
RE-TIED MAY 8, 1970 by L. E. GOULD