

T. 14 S. R. 8 W. W. M.

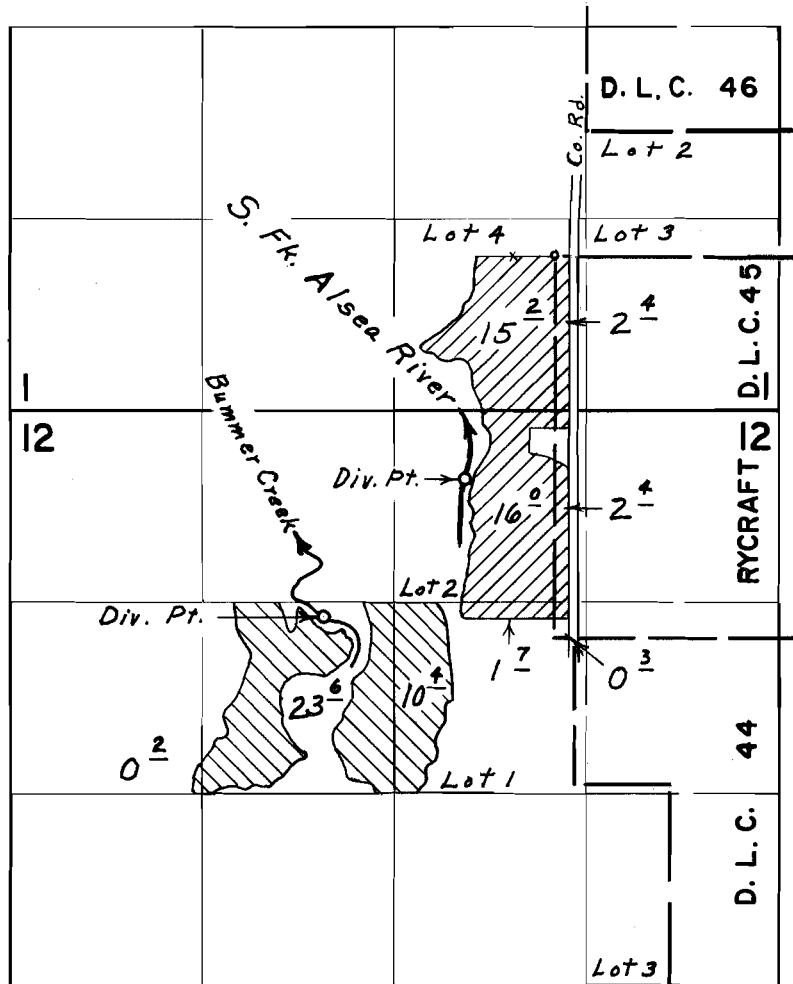

Div. Pts. located: S. Fk. Aisea River, 1530' S. & 620' W.;
 Bummer Creek, 2470' S. & 1580' W.; both from N.W. Cor.
 Rycraft D.L.C. 45

FINAL PROOF SURVEY UNDER

Application No. 43519 Permit No. 32547
43520 32548

IN NAME OF

BENNIE WREN

Surveyed Sept. 9, 1970, by L. E. Gould