

T. 38 S. R. 5 W. W.M.

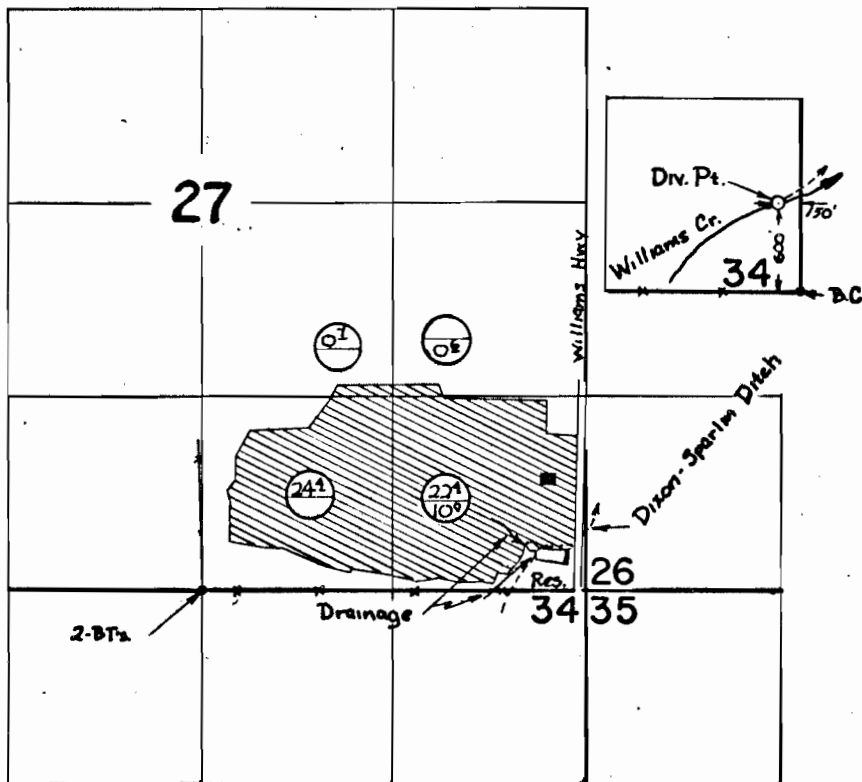

Reservoir Located 2480 ft. E. & 200 ft. N. from S. 4 Cor. Section 27

○ Primary Supplemental (Cert 16343)

FINAL PROOF SURVEY UNDER

R38650 R3263
Application No. 38651 Permit No. 28814
IN NAME OF

HAROLD P. & VIRGINIA SANDERS

Surveyed 15 APR. 1970, by D. R. BUELL