

Map for Homer M. McCullough
 showing area for
 Permit to appropriate the Public Waters of
 the State of Oregon
 SE 1/4 NE 1/4 & Lot 1, Sec. 23, T17S-R1W

Scale: 1" = 400'

M. D. H. Nov. '66

APPLICATION No. 43016
 PERMIT No.

Application No. 43016
 Permit No. 31860

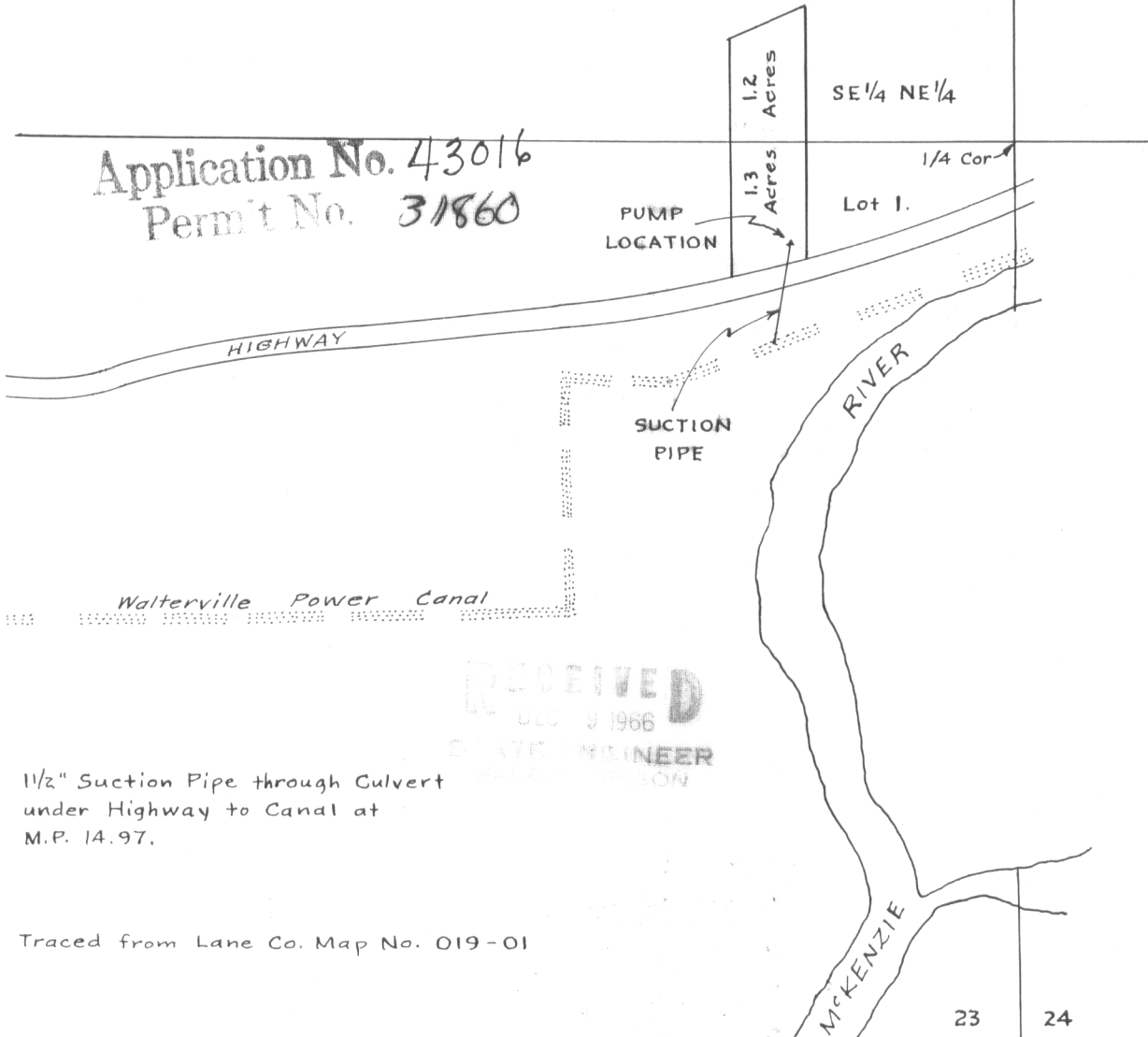

RECEIVED
 DEC 9 1966
 STATE ENGINEER
 WASHINGTON

1 1/2" Suction Pipe through Culvert
 under Highway to Canal at
 M.P. 14.97.

Traced from Lane Co. Map No. 019-01