

T. 25 S. R. 6 W. W.M.

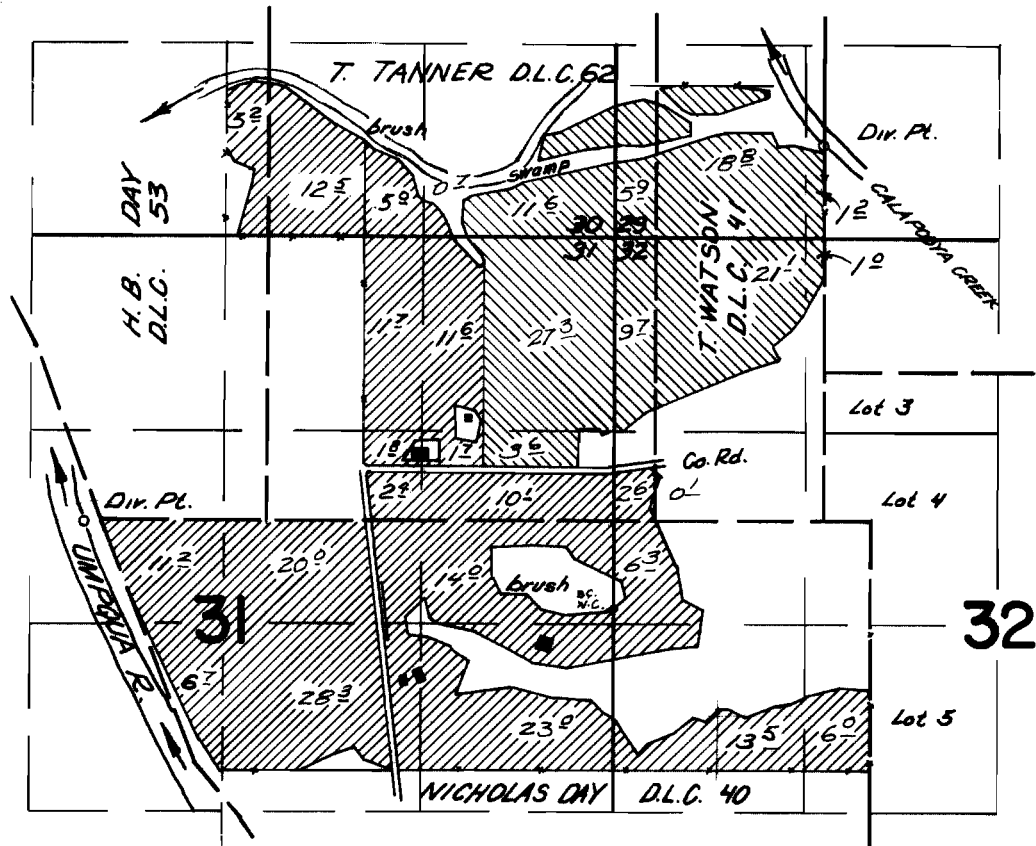

DIV. PTS. LOCATED: CREEK 3390 FT. N. & 1420 FT. E.; RIVER 700 FT. N. & 3620 FT. W. BOTH FROM THE E 1/4 CORNER OF SECTION 31

FINAL PROOF SURVEY UNDER

CREEK 
RIVER 

Application No. 37623... Permit No. 28110...
IN NAME OF

McClellan O. and Dorothy B. Knapp
Paul J. Frost
Surveyed April 20, 1967, by *V. Garner*...