

# T.22S.R5W.W.M.

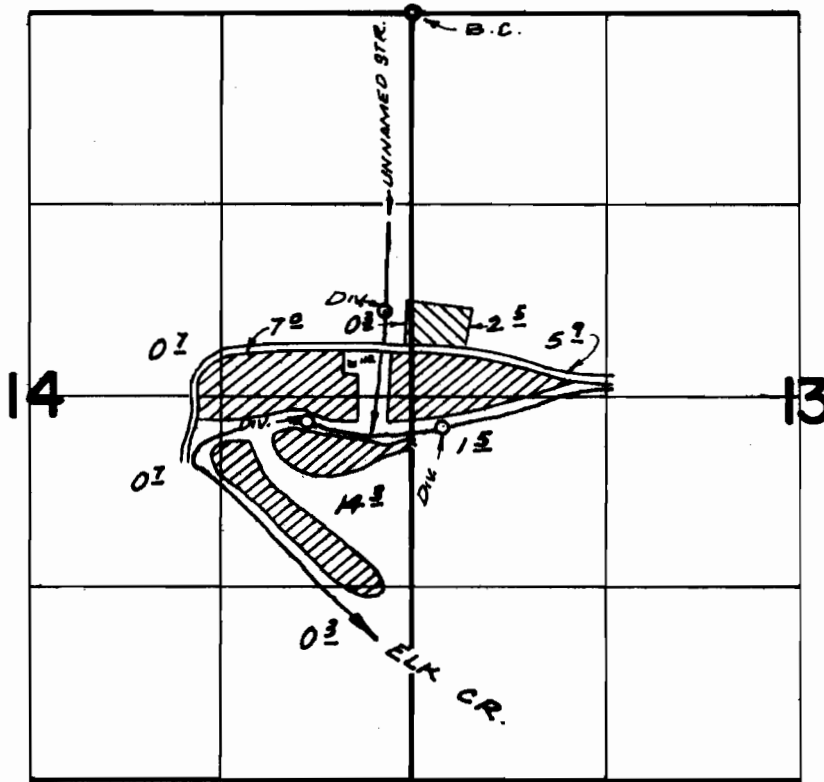

DIV. PTS. LOC: ELKCR. - 2800'S. & 720' W.; 2820'S. & 210'E, UNN.  
STR. - 2050'S. & 180' W, ALL FROM N.E. COR. SEC. 14

## FINAL PROOF SURVEY

UNDER

Application No. 41276 Permit No. 30779

IN NAME OF

H. M. WILDER

Surveyed JUNE 12, 1970, by R. MUCKEN