

FEB

7758
4958

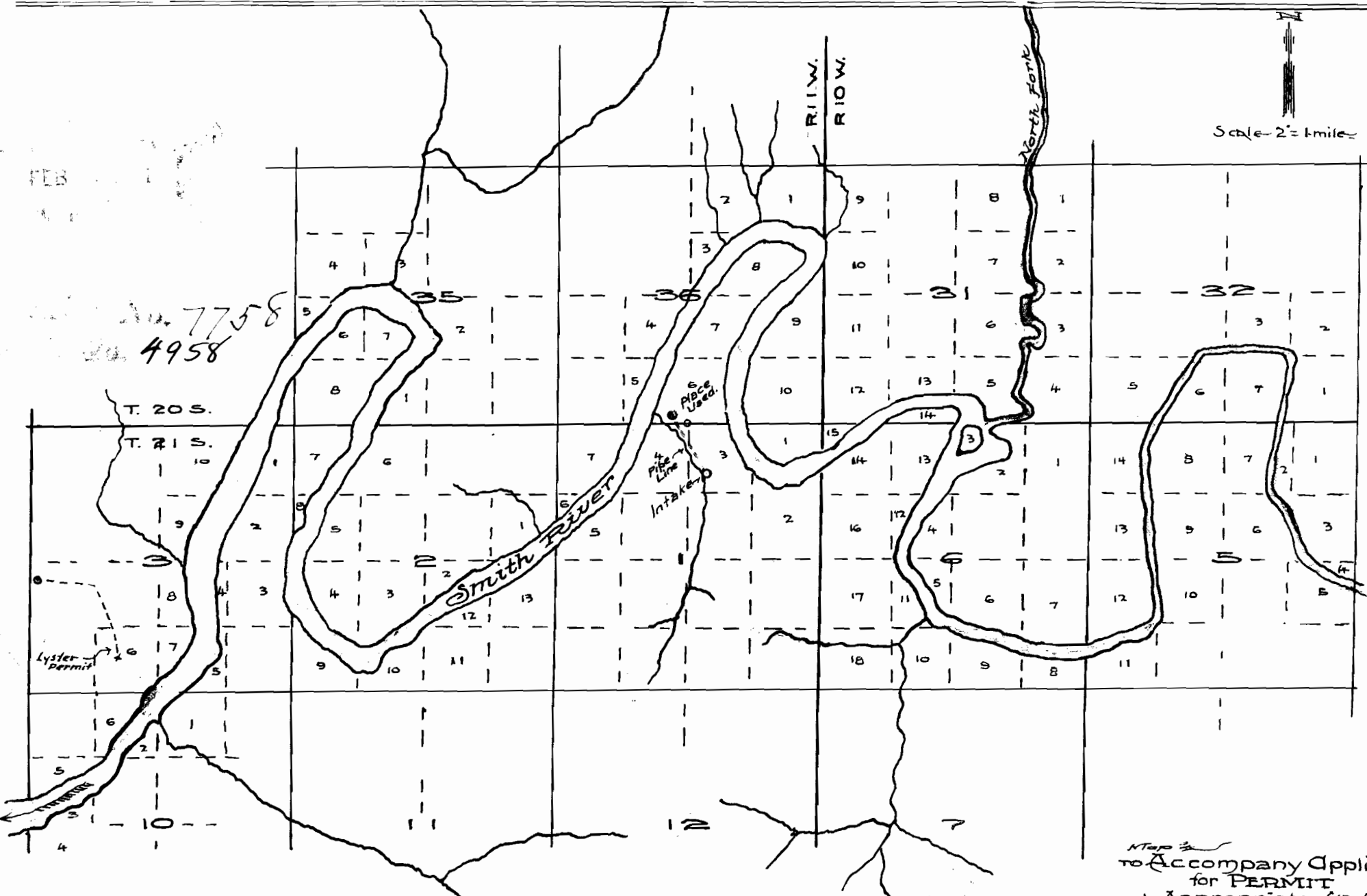

Application No.
Permit No.

I, E.L. Robinson, of Reedsport, Ore. hereby Certify that this map is made from notes of an actual survey made by me Feb. 11-1921 and that it correctly represents the works described in the accompanying application, together with streams etc., in the vicinity.

E.L. Robinson
surveyor.

MAP 3
to Accompany Application
for PERMIT
to Appropriate Water.

Charles Henderson,
Applicant.

To the State Engineer
Salem, Oregon.