

# T.13&14S.R.2W.W.M.

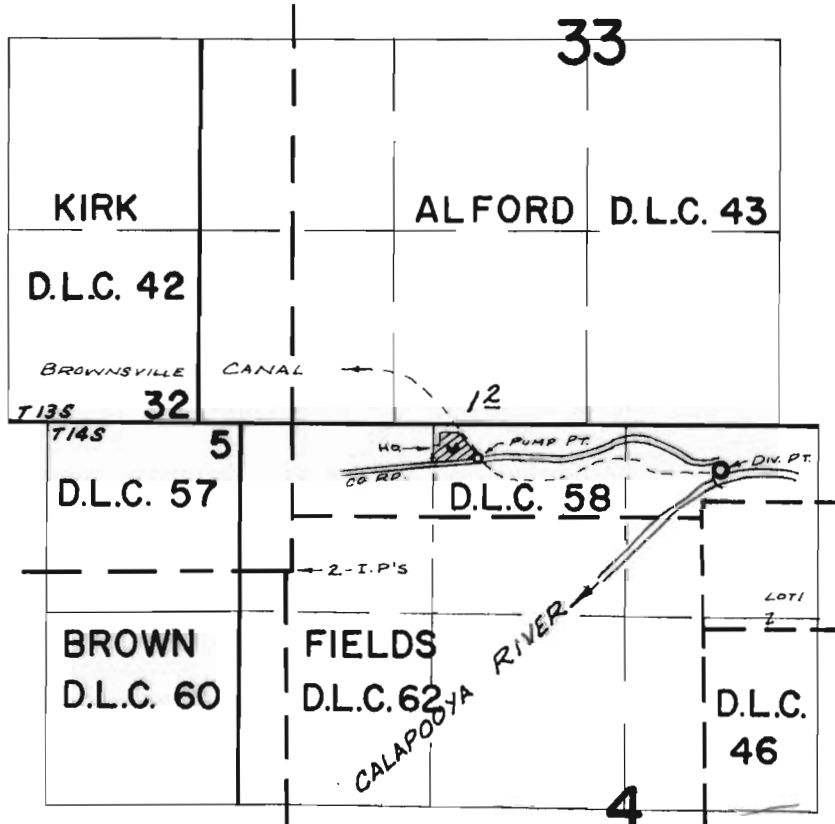

DIV. PT. LOG: 2930'E. & 710'N. FROM S.E. COR. KIRK D.L.C. 57

FINAL PROOF SURVEY  
 UNDER  
 Application No. 41111 Permit No. 30652  
 IN NAME OF  
J. & J. WAIBEL RANCH  
 Surveyed JULY 31, 1970, by R. MUCKEN