

T. 1 S. R. 3 W. W. M.

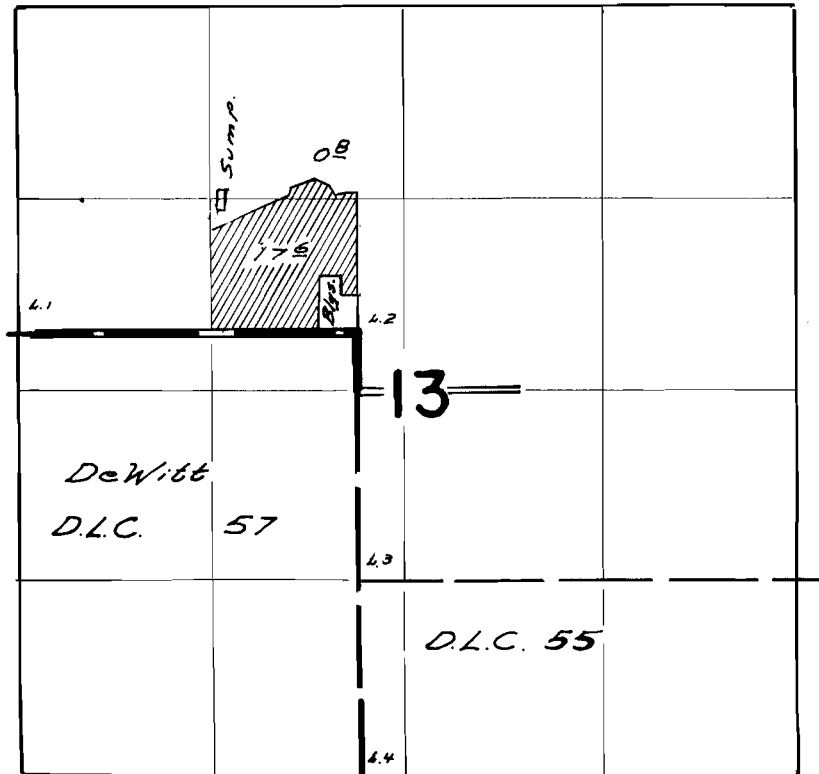

Sump Located 900 ft. N & 930 ft. W From NE. Cor. D.L.C. 57

FINAL PROOF SURVEY
UNDER

Application No. G-2908 Permit No. G-2687
IN NAME OF

DONALD C. JESSE

Surveyed Aug. 25, 1966, by W. d. Ruppert