

T. 8 & 9 S. R. 40 E. W.M.

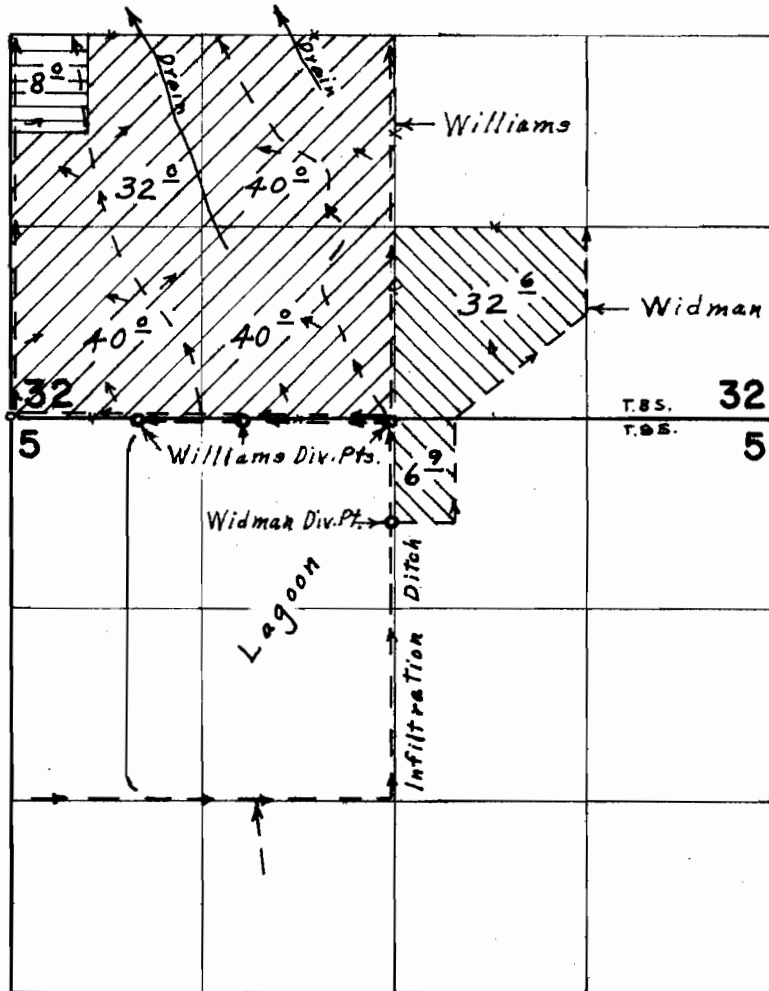

Div. Pts. located: 870' E. & 20' S.; 1590' E. & 20' S.; 2620' E. & 20' S.; 2620' E. & 720' S. all from N.W. Cor. Sec. 5

FINAL PROOF SURVEY

UNDER

Application No. G-3305 Permit No. G-3078

IN NAME OF

FRED WIDMAN & BESSIE WILLIAMS

Surveyed July 16, 1970, by L. E. Gould