

T. 9S. R. 39E. W.M.

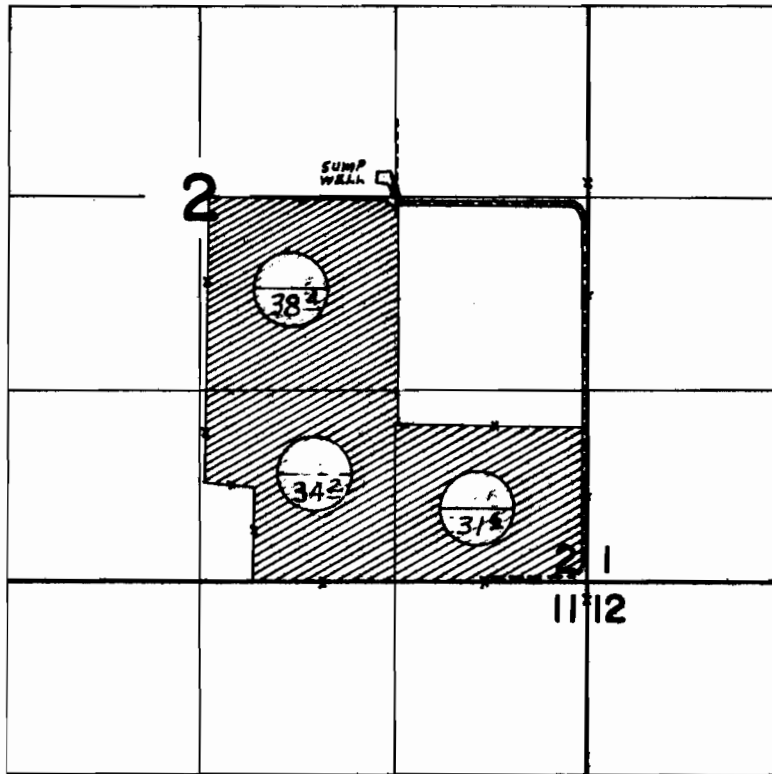

SUMP WELL LOC. 278' N. & 139' W. FROM SE COR. SEC. 2



PRIMARY
SUPPLEMENTAL -

FINAL PROOF SURVEY

UNDER

Application No. G-3729 Permit No. G-3523

IN NAME OF

ORVILLE N. ROHNER

Surveyed JULY 20 19 70, by J. E. GOULD