

T. 14 S. R. 6 W. W. M.

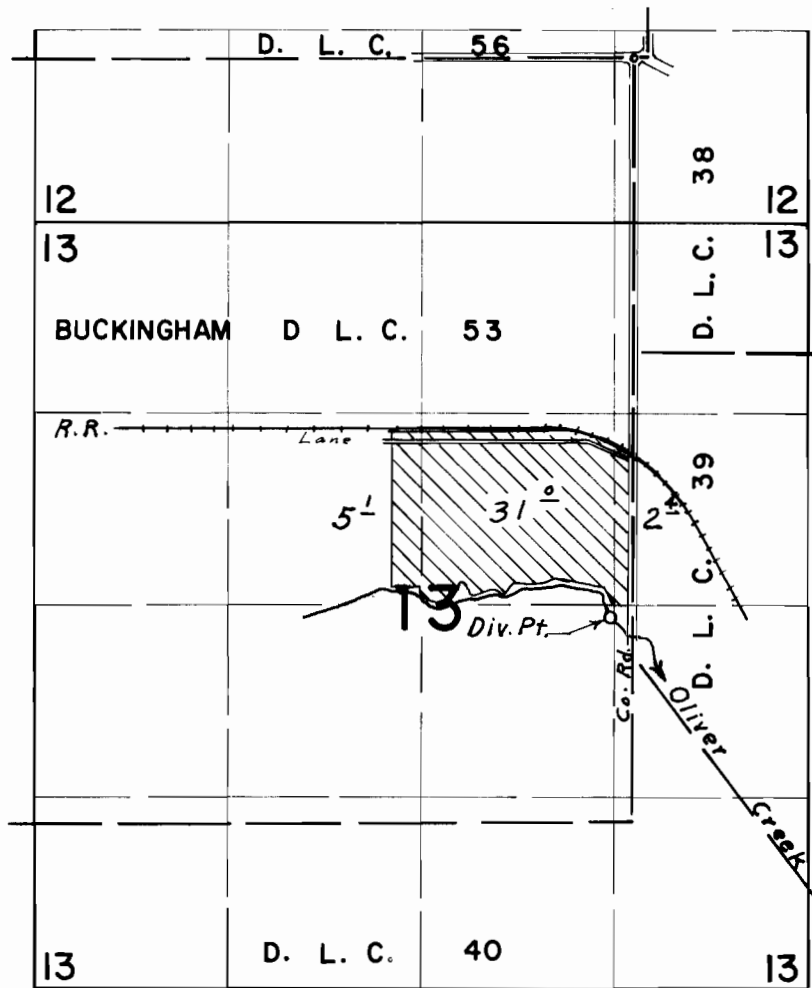

Div. Pt. located 3840' S. & 150' W. from N.E. Cor. Buckingham D.L.C. 53

FINAL PROOF SURVEY UNDER

Application No. 42631 Permit No. 31844
IN NAME OF

THOMAS LEE MOODY

Surveyed Aug. 18, 1970, by L. E. Gould