

T.4S.R.1&2E.W.M.

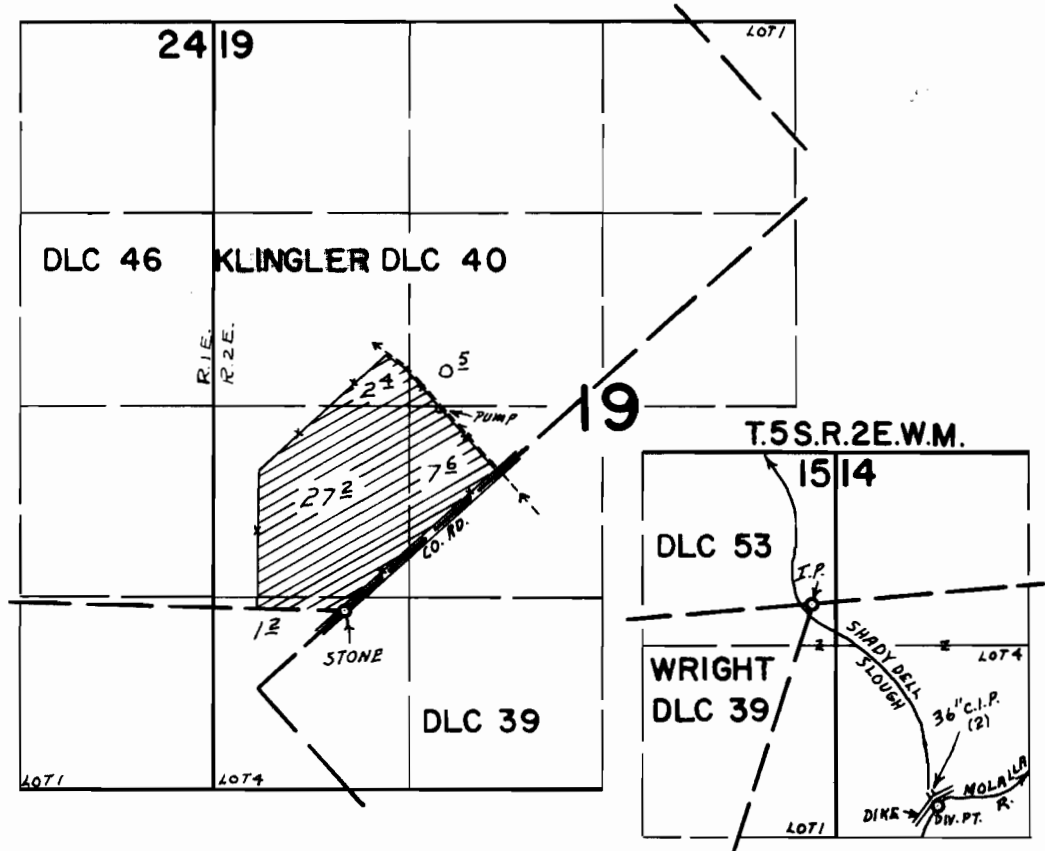

DIV. PT. LOC. 1390'S. & 850'E. FROM NE COR. WRIGHT DLC 39'

FINAL PROOF SURVEY UNDER

Application No. 22650... Permit No. 31257...
IN NAME OF

C. P. WEBSTER

Surveyed SEPT. 17 1970., by A. E. GOULD...